

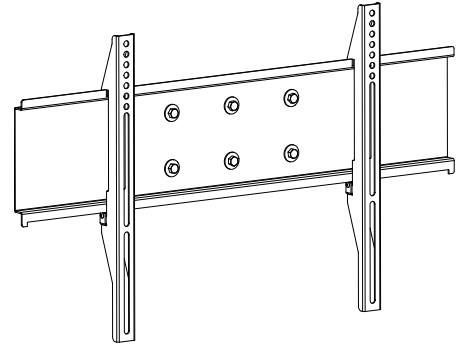


# BRETFORD

## FFPKIT

### FLAT PANEL MOUNT CONVERSION KIT

#### Assembly Instructions

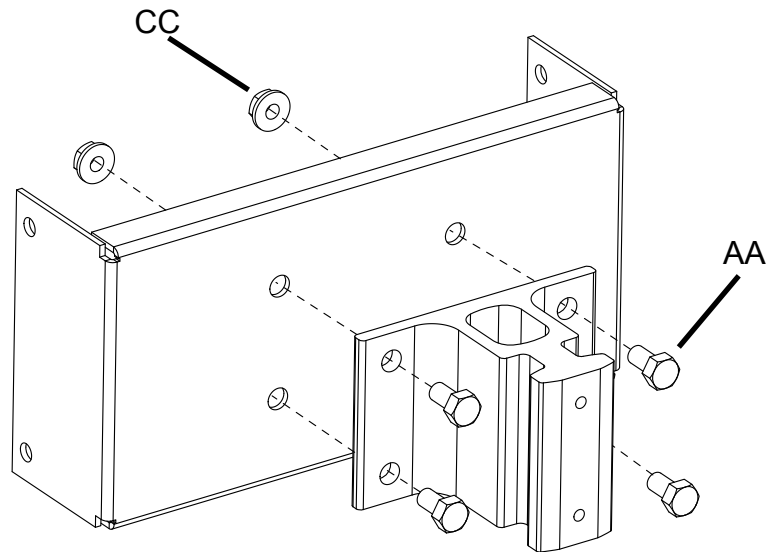


#### PARTS LIST

Qty	Part#	Description	Ref
1	010-5653	Nugget	AA
1	010-4958	Box Swivel	BB
1	010-4959	Swivel Bracket	CC
1	010-4954	Main Support Bar	DD
2	010-4953	Hook Bars	EE
2	010-4956	Stop Brackets	FF
			GG
			HH

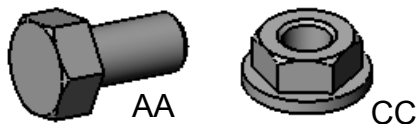
#### HARDWARE LIST

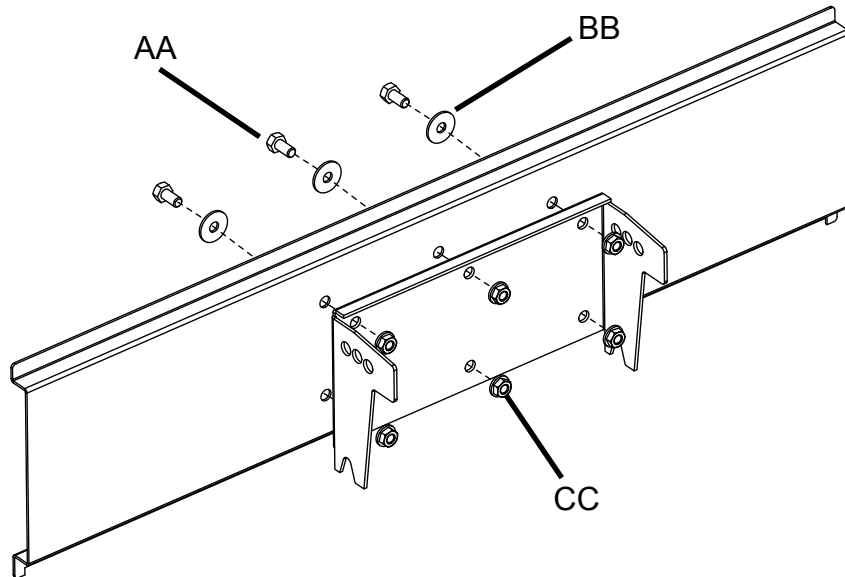
Part#	Description
030-0307	5/16-18 x 5/8" Hex Hd Screws
030-0306	1" x 21/64" x 1/16" Washers
030-0411	5/16-18 Serrated Nuts
030-0713	3/8-16 x 5/8" Button Cap Screws
030-1340	1/4-20 x 2" Hex Hd Bolts
030-0043	#10-1/4" Washers
030-0865	#6 x 1/2" Button Pin-In Hd Screws
030-0354	10-32 x 1 1/2" Button Sockets Screws
030-1352	1/8" Security Pin-In Driver Bit
044-2124	Courtesy Monitor Hardware Pack



#### STEP 1

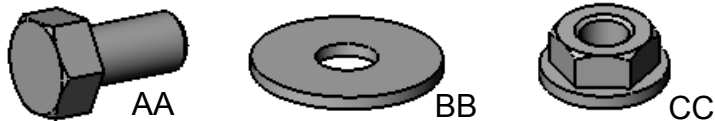
Attach the box swivel to the nugget with screws (AA) and nuts (CC) as shown.



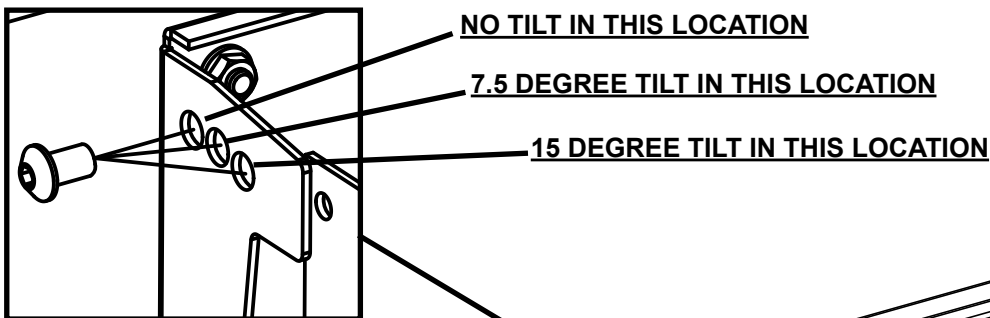


**STEP 2**

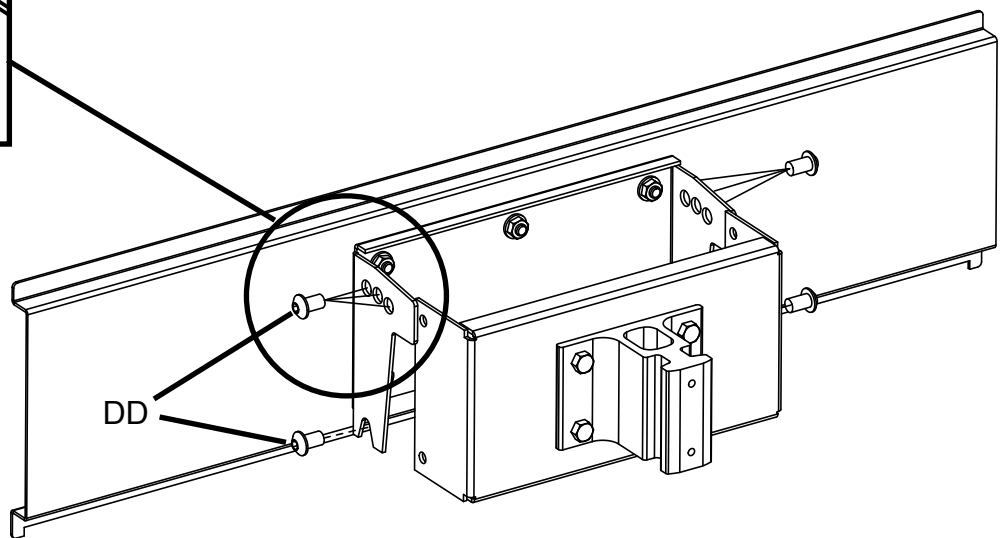
Attach main support to swivel bracket with screws (AA), washers (BB) and nuts (CC) as shown.



**TILT ADJUSTMENTS**

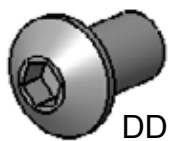


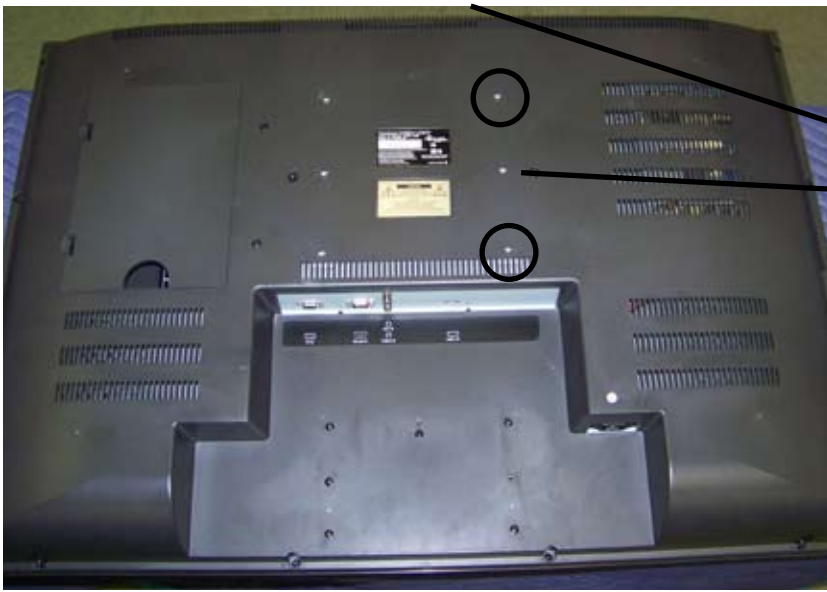
**FIGURE 8**



**STEP 3**

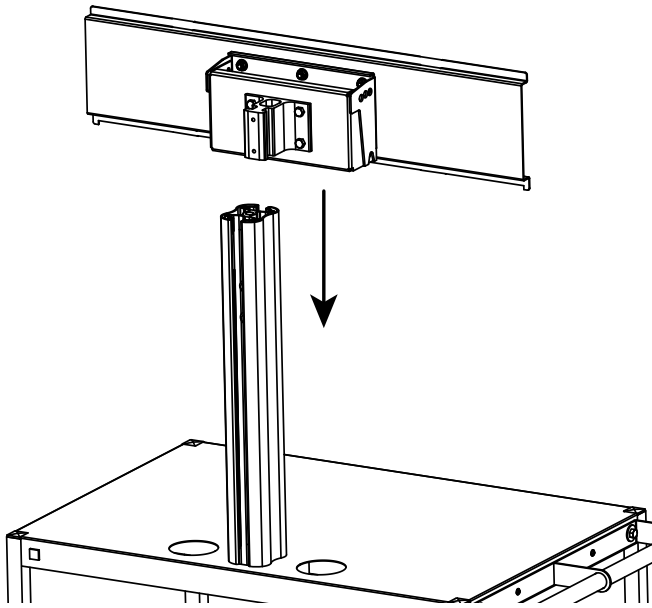
Loosely insert the lower spike/box assembly screws (DD) then fit the spike/box assembly notch over the screws and insert the tilt adjustment screws (DD) at the angle desired and tighten all screws. This assembly can be installed with or without a tilt. Reference **FIGURE 8** for tilt adjustments.



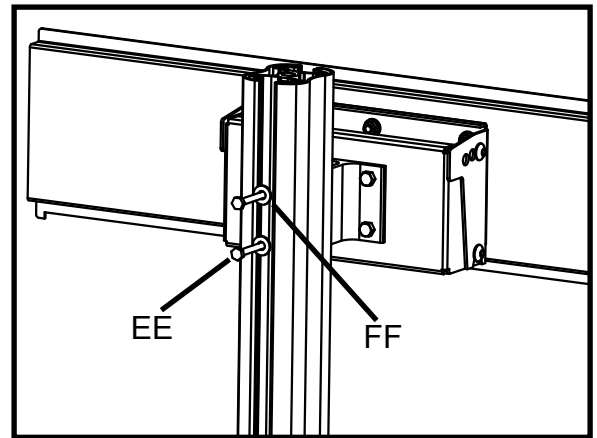


Measure the distance from the center of mount holes to the top of the monitor.

**FIGURE 9**



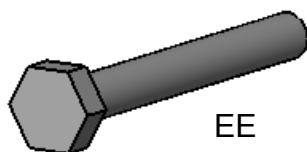
**FIGURE 10**



**FIGURE 11**

**STEP 4**

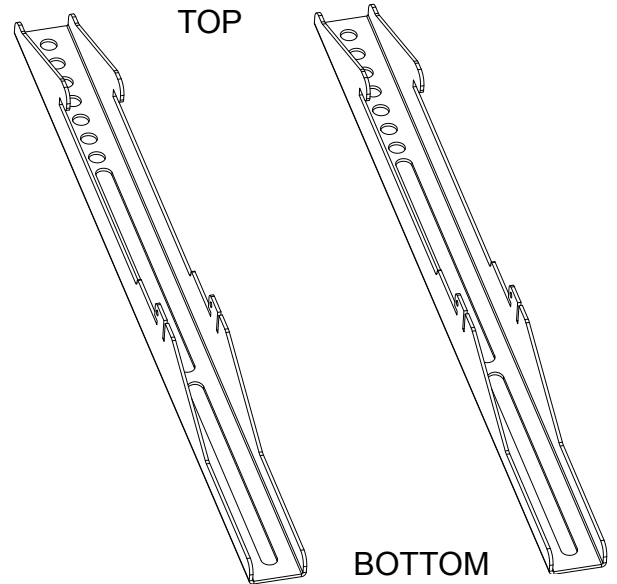
Roughly measure the distance from the center of monitor mounting holes to the top of the monitor (**FIGURE 9**). Round to the highest inch and from the top of the pole, use that measurement as a guide to the location for the top nugget screw on the pole. Slide the nugget assembly onto the pole as shown in **FIGURE 10**. Hand tightening, attach nugget to pole with bolts (EE) and washers (FF) as shown in **FIGURE 11**. **NOTE: You may need to adjust the mounting assembly up or down once the monitor is hung in place. DO NOT OVER TIGHTEN THE BOLTS.**



EE

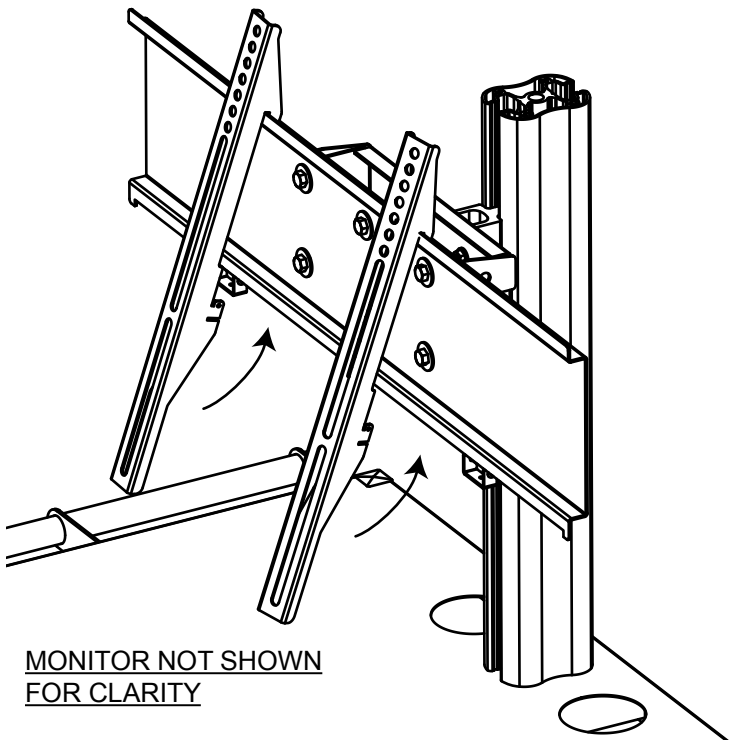


FF



**STEP 5**

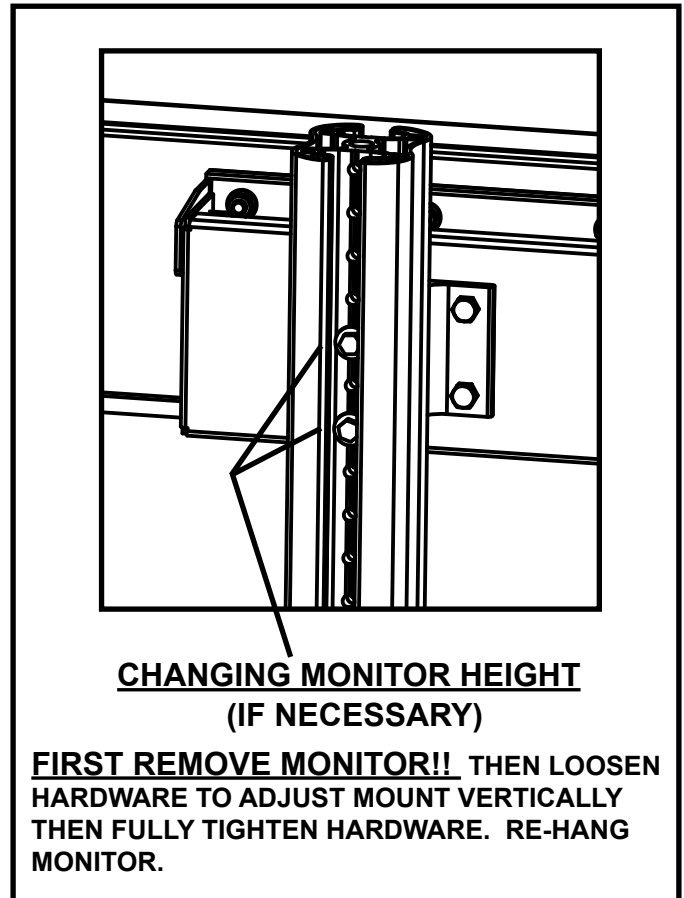
Attach both hook bars onto the back of your monitor using the mounting holes built into the case. A courtesy hardware pack has been provided with several metric screw sizes. You may need to purchase additional metric screws from your local hardware store for odd shaped monitors.



MONITOR NOT SHOWN FOR CLARITY

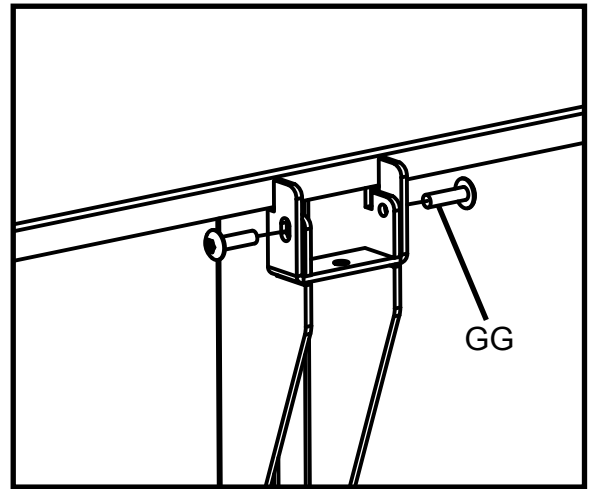
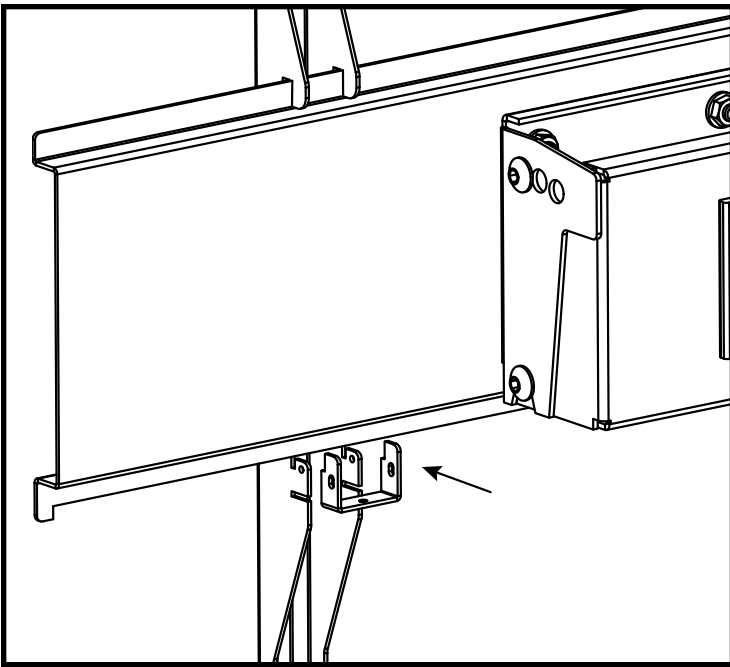
**STEP 6**

Hook monitor onto main support bar as shown. Monitor removed from picture for clarity.



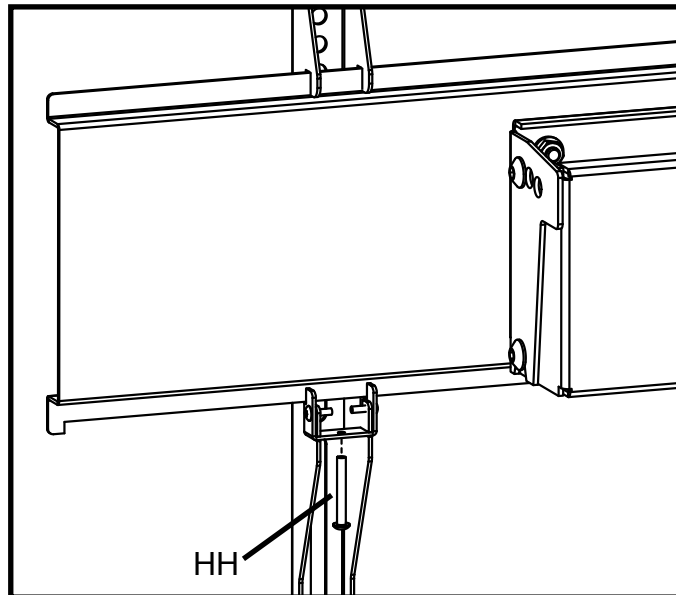
**CHANGING MONITOR HEIGHT (IF NECESSARY)**

**FIRST REMOVE MONITOR!! THEN LOOSEN HARDWARE TO ADJUST MOUNT VERTICALLY THEN FULLY TIGHTEN HARDWARE. RE-HANG MONITOR.**



**STEP 7**

Attach the stop brackets to the hook bars as shown with security screws (GG) using the driver bit provided.



**CENTER MONITOR HORIZONTALLY THEN SECURE**

**STEP 8**

Center your monitor horizontally and then tighten in place with screws (HH).



Bretford  
 11000 Seymour Avenue  
 Franklin Park, IL 60131  
 TEL: 847.678.2545  
 800.521.9614  
 FAX: 847.678.0852  
 800.343.1779

Bretford Ltd.  
 2 Etongate  
 110 Windsor Road, Slough  
 Berkshire SL1 2JA England  
 TEL: 011 44 17 5353 9955  
 FAX: 011 44 17 5353 9478