



BRETFORD™

FPCM-1-AL FPCM-2-AL
 FPCMPOLE36 FPCMPOLE48
 FPCMPOLE60 FPCMPOLE72

UNIVERSAL FLAT PANEL
 CEILING MOUNT AND POLES

Assembly Instructions

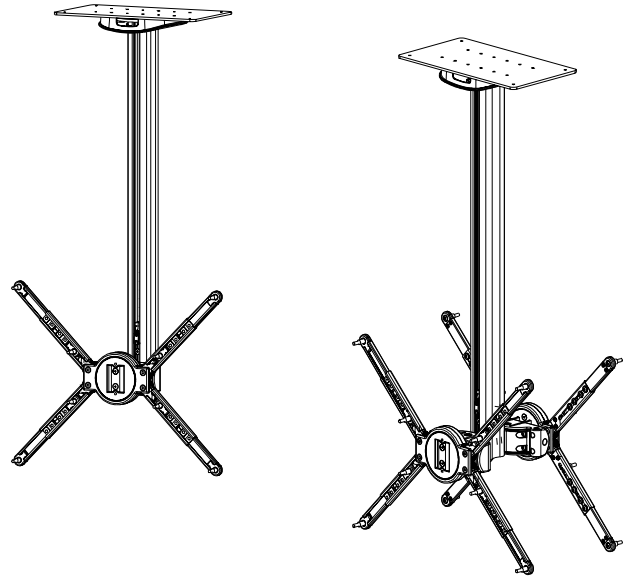

Hardware List

Ref.	Qty.	Part No.	Description
AA	4	030-1177	#12 x 2 1/2" Flat Head Wood Screws
BB	4	030-1165	5/16-18 UNC 1/2" Flat Hd Screws
CC	4	030-1164	1/4-20 UNC 1 1/4" Flat Hd Screws
DD	1	030-1166	5/8-18 UNC 1 1/4" Flat Hd Screw
EE	4	030-1111	5/16-18 UNC .050 Thick Washers
FF	4	030-1167	5/16-18 UNC 5/8" Button Hd Screws
	1/2	044-1981	Courtesy Hardware Pack for Mounting Monitor (1) for FPCM-1-AL & (2) for FPCM-2-AL
	2/4	012-0761	Cable Clips (1) for FPCM-1-AL & (2) for FPCM-2-AL
	1	030-0353	1/8" T-Handle Allen Wrench
	1	030-0397	3/16" Allen Wrench
	1	HK1020	5/32" Allen Wrench
	1	030-1238	3/8" Allen Wrench

SAFETY WARNING
Note: TWO PERSON
ASSEMBLY REQUIRED

CAUTION: This mount is intended to support a LCD monitor each having a diagonal screen size of 60" and a maximum weight of 170 lbs. Use of any larger size monitors may result in instability causing possible injury. The wall mounting hardware included in your hardware pack is **INTENDED for WOOD STUD INSTALLATION ONLY**. For added safety and ease of installation, use a qualified professional to properly install the correct mounting hardware. Bretford will not be liable for the improper use or installation of its products.

****MOUNTING YOUR MONITOR**

While Bretford has tried to provide hardware to accommodate as many styles of large monitors as possible, since new monitor designs are constantly entering the market, your monitor may require special hardware not included with this model. If you feel your monitor requires different hardware that was not provided and you need assistance determining the correct hardware, consult Bretford's customer service department, the monitor manufacturer or a dependable hardware supplier. **NOTE:** The minimum thread engagement required is the same as the diameter of the screw, for instance, if the screw diameter is 8mm, the minimum thread engagement is also 8mm.

WARNING

The monitor bracket screws must be fully seated in the back of the monitor in order to create a stable installation. If the monitor bracket screws are not fully seated, your installation will not be stable and personal injury or damage to your monitor may result.

When mounting monitor brackets, do not use screws that exceed the depth of the monitor mounting holes. Using screws that are too long may cause damage to your monitor. Never tighten fasteners past the first sign of resistance. Over tightening may cause serious damage to your monitor. Any doubt, the installer should consult monitor manufacturer for mounting hole depth guidelines.

CEILING

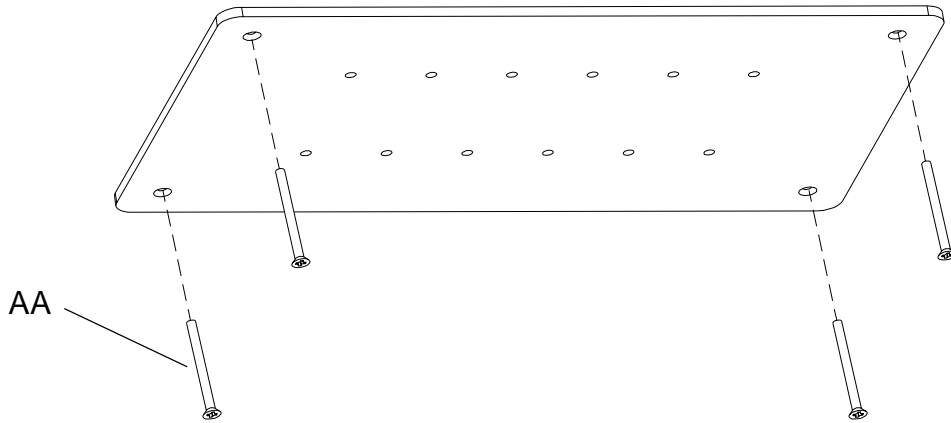

STEP 1

Attach the ceiling plate to your ceiling through a wood stud using screws (AA) as shown. **NOTE:** This plate is meant for studs on 18" centers.

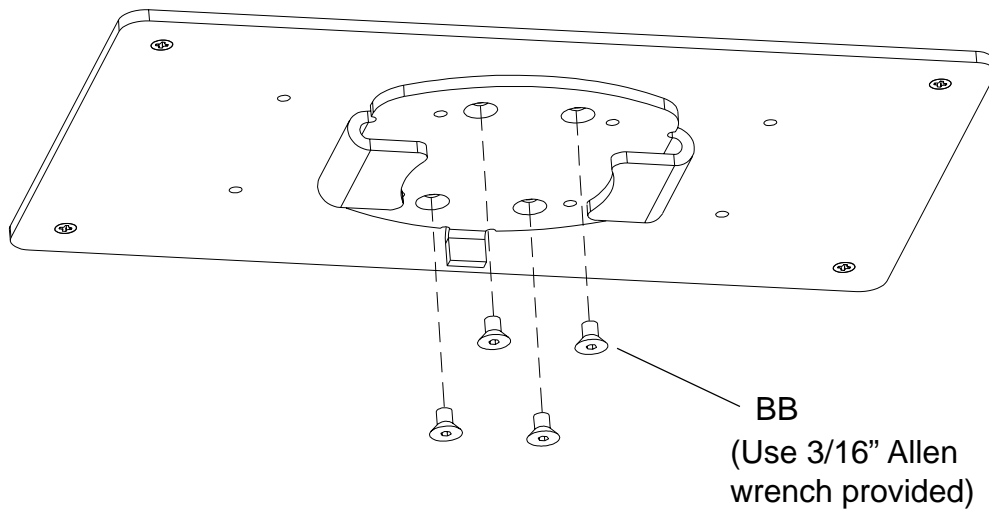

STEP 2

Attach the mount clip to the ceiling plate with screws (BB) as shown.

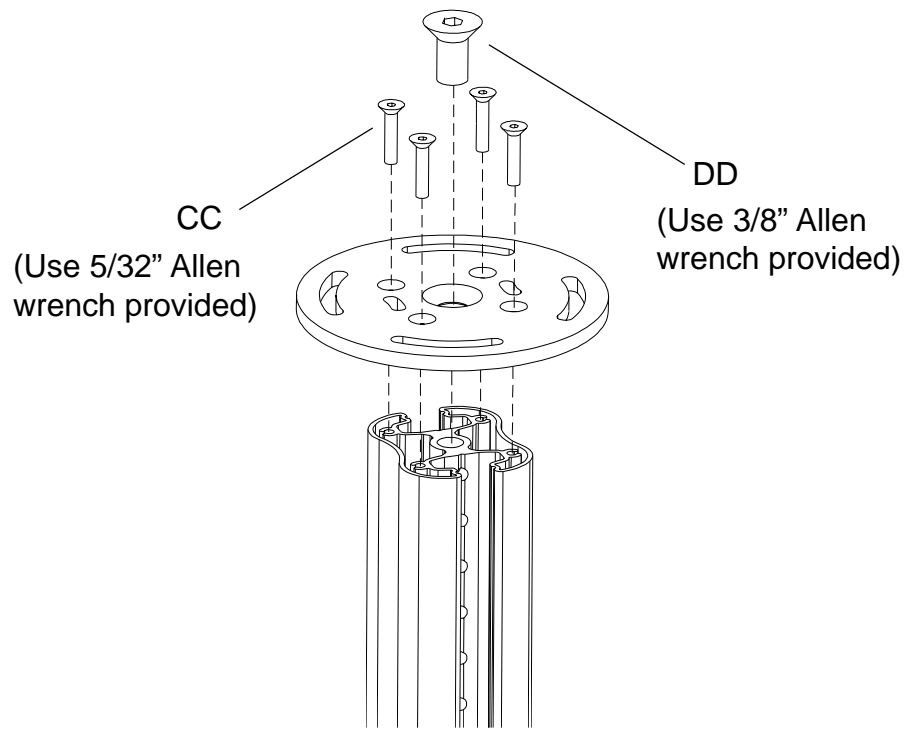

STEP 3

Attach the pole plate to the pole extrusion using screws (CC) and (DD) as shown. **NOTE:** A 5/32" Allen Wrench is needed for screw (CC) and a 3/8" Allen Wrench for screw (DD).

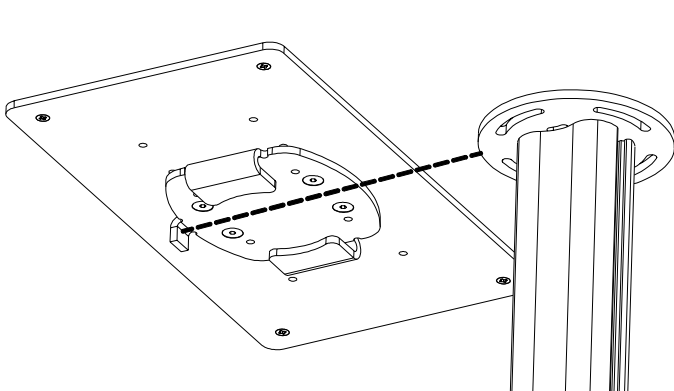

FIGURE 1

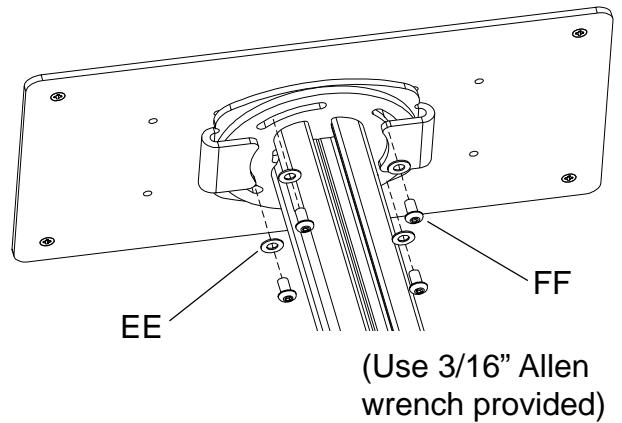
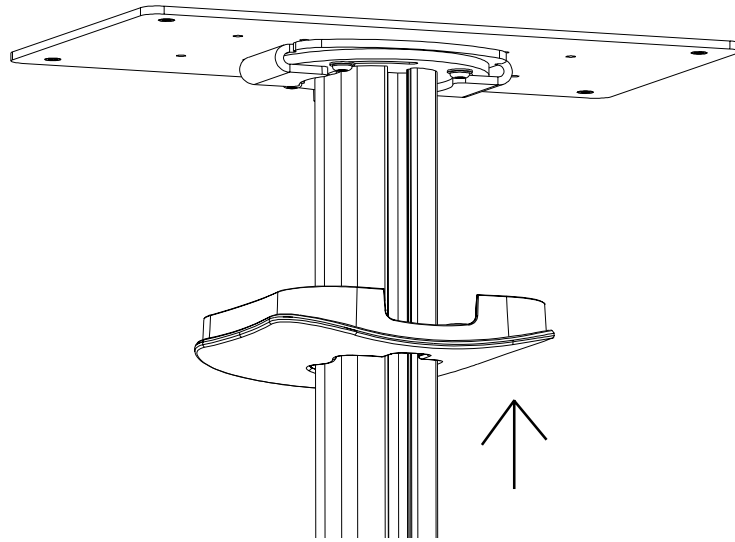

FIGURE 2

STEP 4

First slide pole assembly onto mount clip as shown in **FIGURE 1**. The secure both plates together with washers (EE) and screws (FF) as shown in **FIGURE 2**.



STEP 5

Slide the plastic pole shroud onto the pole assembly.
Both sides of shroud should snap in place.

****MOUNT YOUR MONITOR NOW USING COMPONENTS PROVIDED IN THE COURTESY HARDWARE PACK**

ARM ADJUSTMENTS

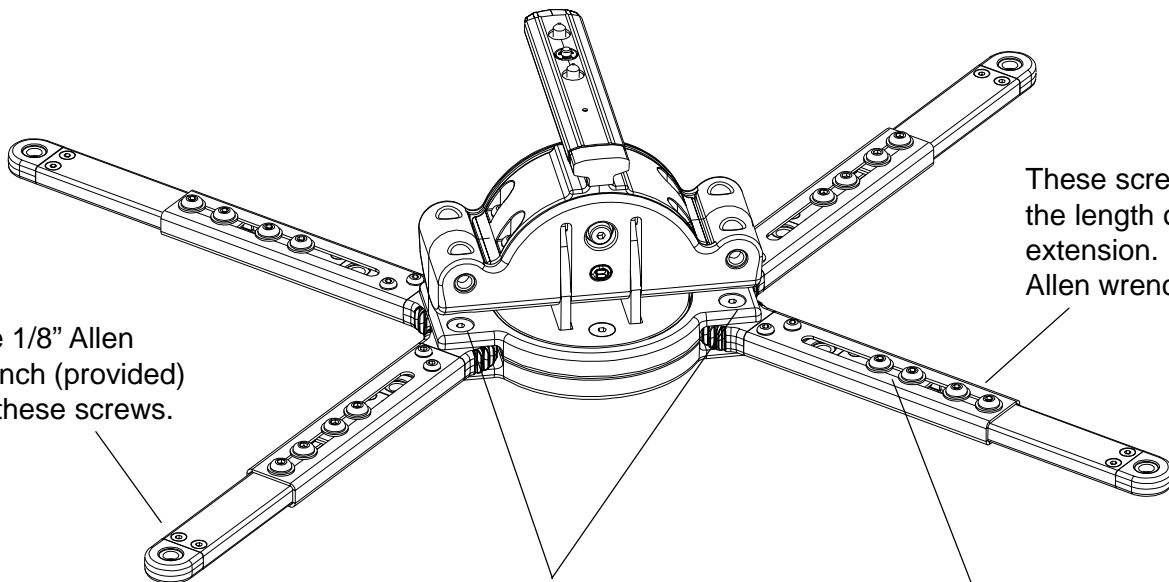

Use 1/8" Allen wrench (provided) for these screws.

These screws adjust the length of the arm extension. Use 3/16" Allen wrench provided.

Loosen these corner screws to open and close the arms. Once location of arms is achieved, tighten screws. Use 3/16" Allen wrench

These screws hold a smaller arm extension. If a shorter arm is needed take arm extensions apart and just use the shorter one. Use 3/16" Allen wrench provided.

THIS STEP CANNOT BE PERFORMED ALONE. YOU MUST HAVE AT LEAST 2 OTHER PEOPLE ASSIST YOU.

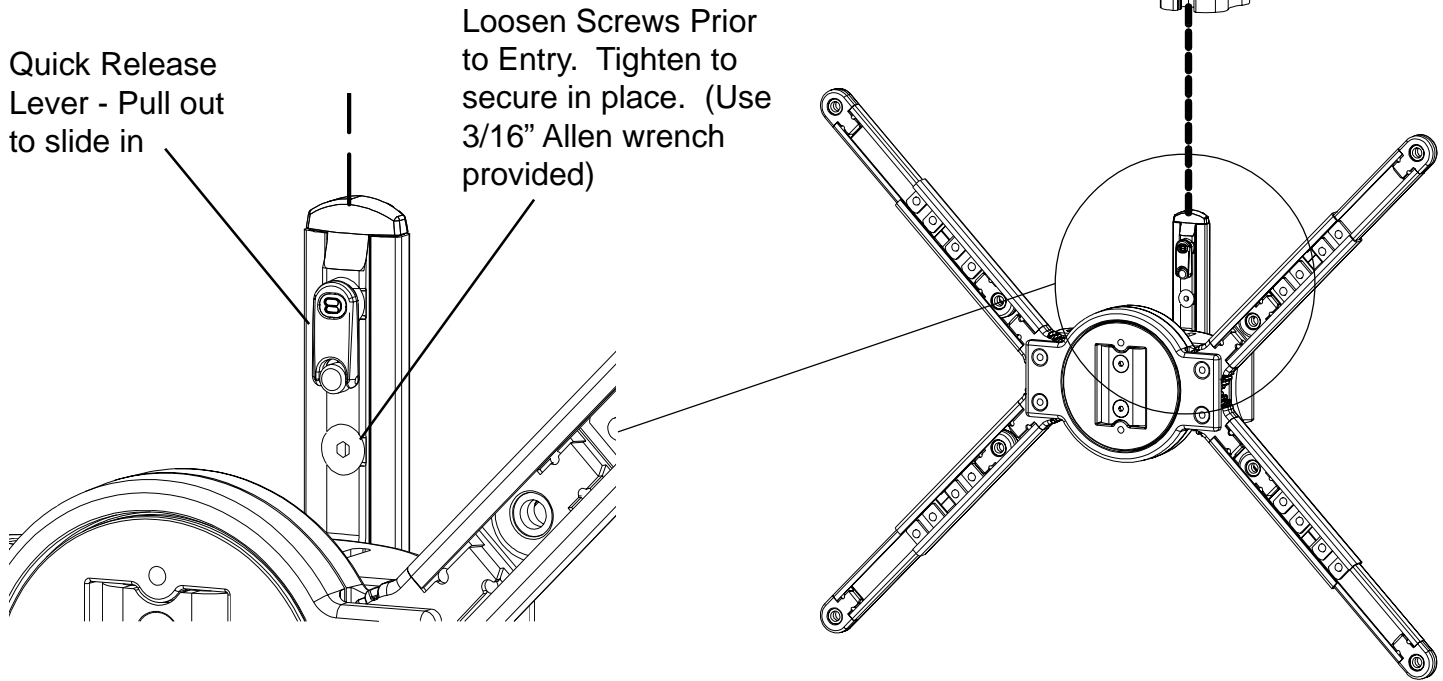

MONITOR NOT SHOWN FOR CLARITY

STEP 7

With someone's help, slide the monitor mount assembly into the pole. **NOTE:** Make sure the screws in the spike are loosened and the release lever is pull out while sliding in spike. Once desired location is determined, tighten spike screws.

FOR MODEL FPCM-2-AL, MOUNT OTHER ASSEMBLY ON THE OPPOSITE SIDE OF THE POLE IN THE SAME MANNER AS DESCRIBED ABOVE.

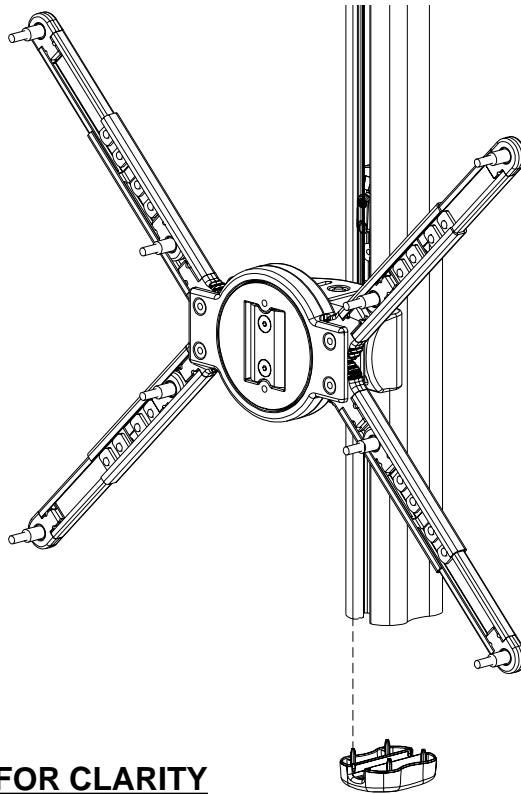

MONITOR NOT SHOWN FOR CLARITY

STEP 8

Snap end cap onto the bottom of the pole as shown.

POLE ADJUSTMENTS

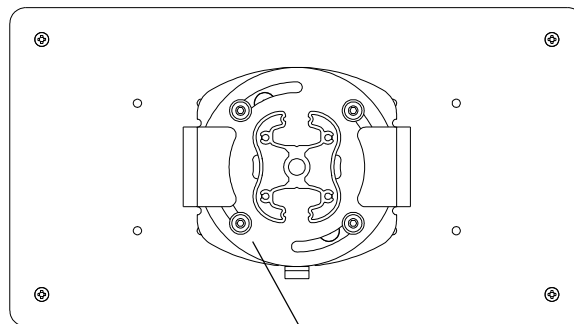

Flatten View Shown for Clarity

Loosen these screws to **adjust pole position.**
Tighten once desired location is achieved.

(Use 3/16" Allen wrench provided)

MONITOR ADJUSTMENTS

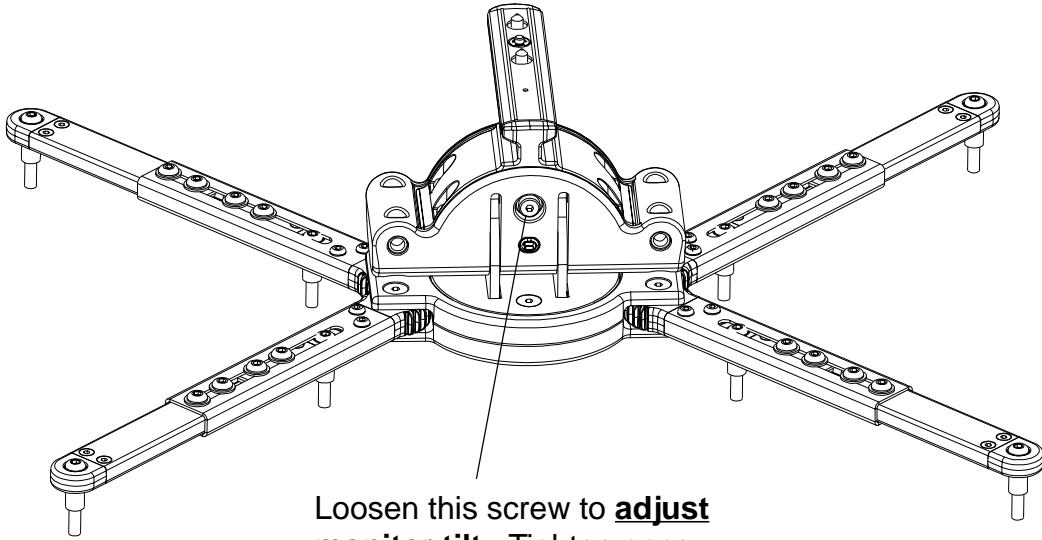

Loosen this screw to **adjust monitor tilt**. Tighten once desired location is achieved.

(Use 3/16" Allen wrench provided)

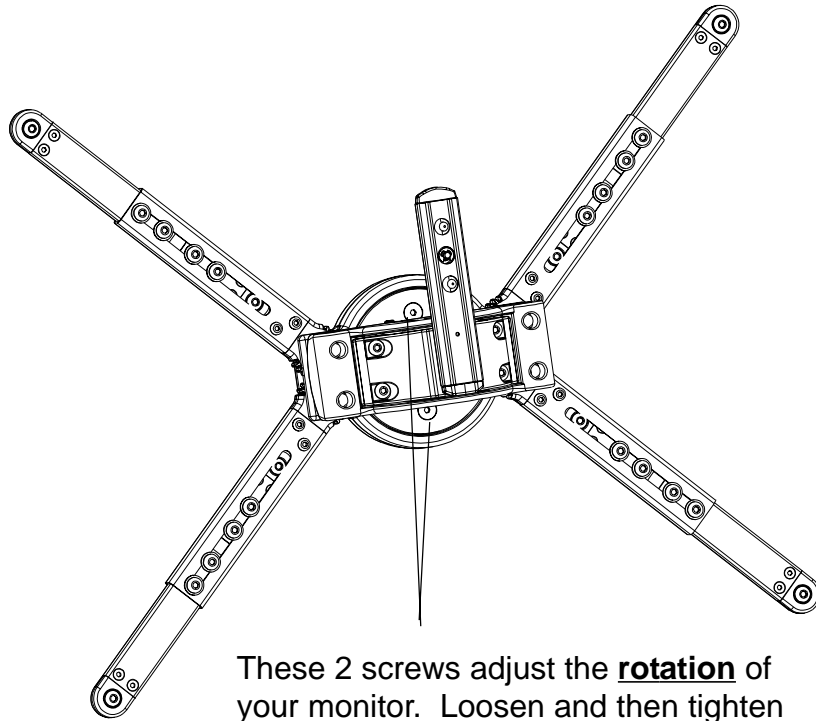

These 2 screws adjust the **rotation** of your monitor. Loosen and then tighten once desired location is achieved.

(Use 3/16" Allen wrench provided)

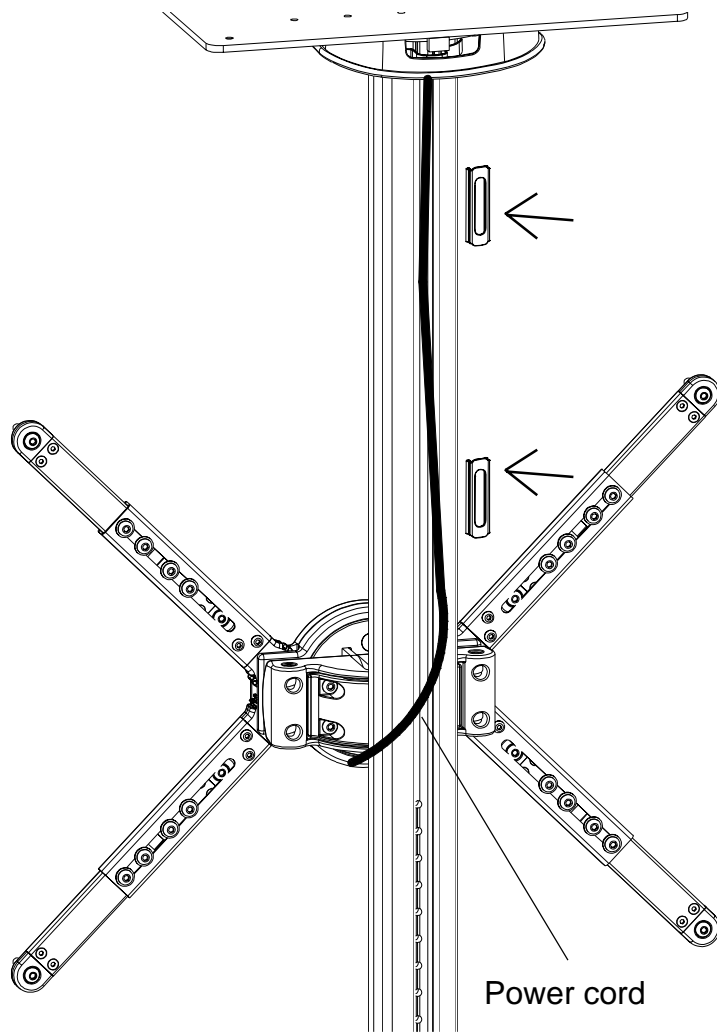

Feed power cord into beam then snap clips inside beam to contain power cord.

Bretford
11000 Seymour Avenue
Franklin Park, IL 60131
TEL: 847.678.2545
800.521.9614
FAX: 847.678.0852
800.343.1779

Bretford Ltd.
2 Etongate
110 Windsor Road
Slough, Berkshire SL1 2JA England
TEL: 01753 216531
FAX: 01753 539478

www.bretford.com

Part # 031-7265
Rev. 08.07.06 CZ