



# BRETFORD

## EC8

### Computer Workstation with CPU Holder

### Assembly Instructions

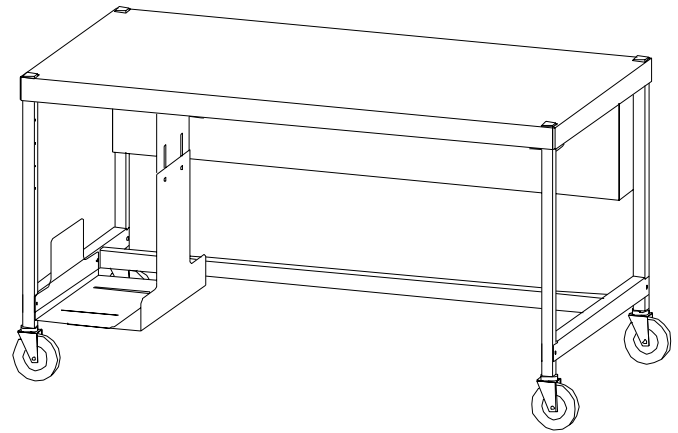

#### PARTS LIST

Qty	Part#	Description	Ref
1	010-3056	CPU Top Bracket	AA
1	010-3057	CPU Bottom Bracket	BB
1	010-3058	CPU Side Bracket	CC
1	010-3059	CPU Locking Slide Bracket	DD
4	017-0377	Front and Rear Legs	EE
1	022-1947	Top Assembly	FF
1	022-1948	Wire Tray Assembly	GG
1	022-1949	H-Frame Assembly	HH
2	015-0002	4" Casters w/o Lock	II
2	015-0003	4" Casters w/ Lock	JJ

#### HARDWARE LIST

Qty	Part#	Description
4	030-0200	1/4-20 x 1" Hex head Screw
4	030-0120	1/4-20 Square Nut
8	030-0383	#10 x 1/2" Truss Head Screw
3	030-0147	1/4-20 x 1 1/4" Machine Screw
6	030-0148	1/4-20 Acorn Nut
2	030-0325	1/4-20 x 1/2" Combo Truss Screw
1	030-0474BK	1/4-20 x 7/8" Flat Hd. Allen Screw
1	SC1047BK	1/4-20 x 37.5mm Connector Bolt
2	030-0305	7/8" Washer
3	030-0207	1/4-20 Flanged Hex Nut
4	030-0272	1/4-20 x 1/2" Carriage Bolt
4	030-0306	1" Washer
1	010-1106	Hex Wrench
1	HK1020	Standard Allen Wrench

#### TOOLS REQUIRED

- Phillips Screwdriver
- Adjustable Wrench
- Rubber Mallet
- Hex Wrench (provided)

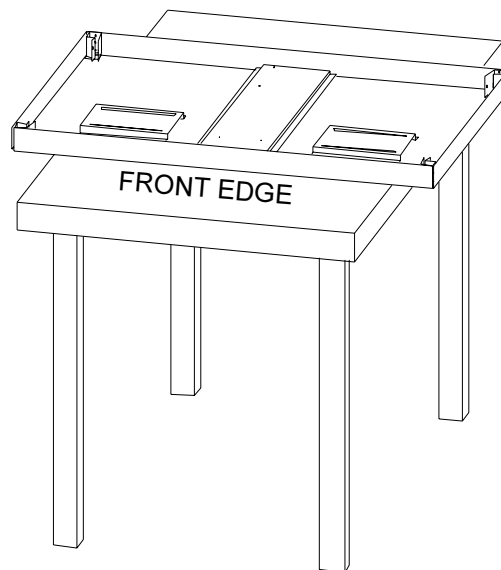

#### STEP 1

Lay the top shelf on a table so that the square brackets and stiffener face up and the 4 corners hang over the table as shown.

**NOTE:** The logo label represents the front edge of the top.

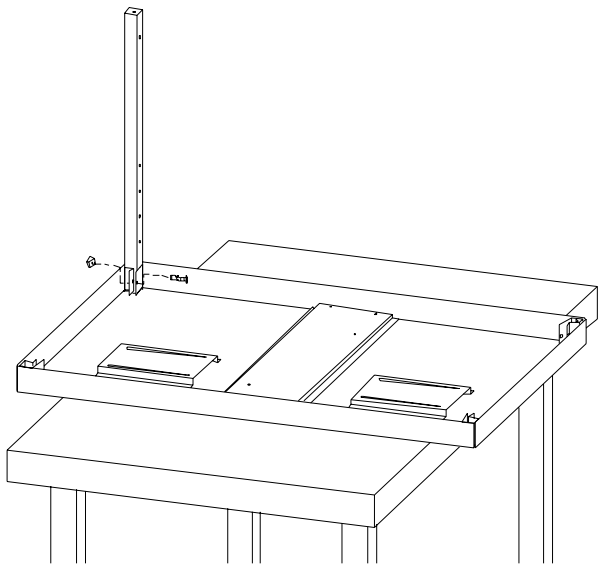

### STEP 2

Position one leg into the square bracket so that the capped end is flush with the top of the shelf and the holes face in as shown. **LOOSELY** attach with screws (AA) and nuts (BB). Attach the remaining 3 legs in the same manner.



AA

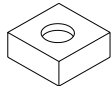

BB

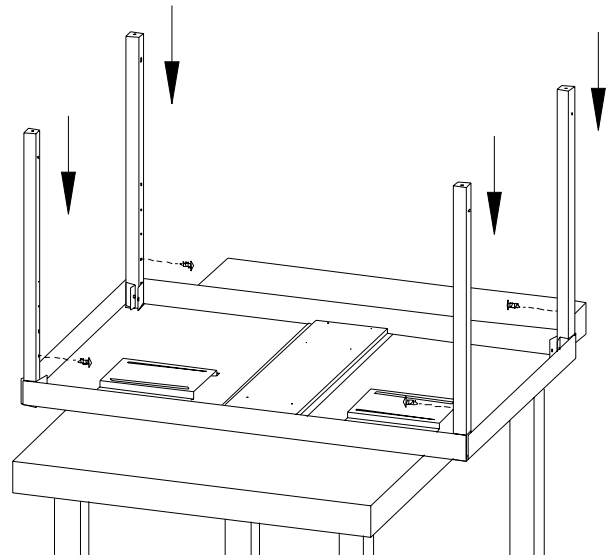

### STEP 3

Insert a self tapping screw (CC) approximately 3/4 of the way into the first hole in each leg. Slide each leg down so that the square bracket **rests on the shaft of the self tapping screw**, not the head of the screw. **TIGHTEN ALL SHELF HARDWARE.**

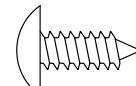

CC

LEAVE OPEN FOR CPU HOLDER (It can be the right or left side)

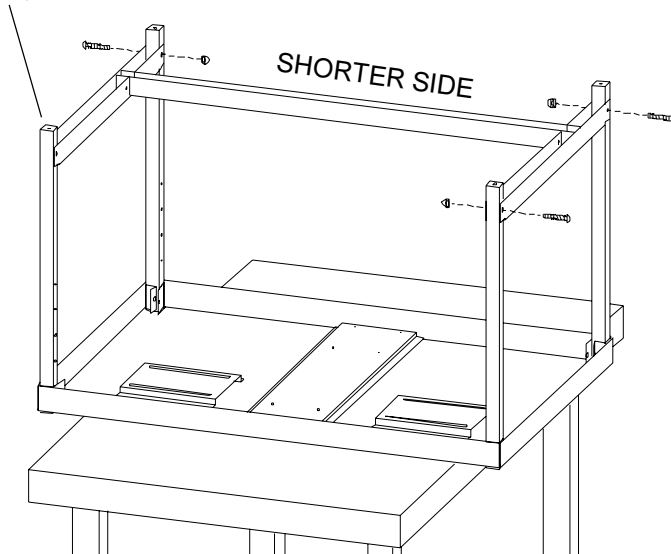

### STEP 4

Slide the H-frame between the legs as shown. **The shorter side faces the rear.** Secure the frame to the legs using screws (DD) and nuts (EE) as shown. **NOTE:** One leg on the front side **DOES NOT GET HARDWARE**, this is left open for the CPU holder. You decide whether to leave the right or left side open.



DD



EE

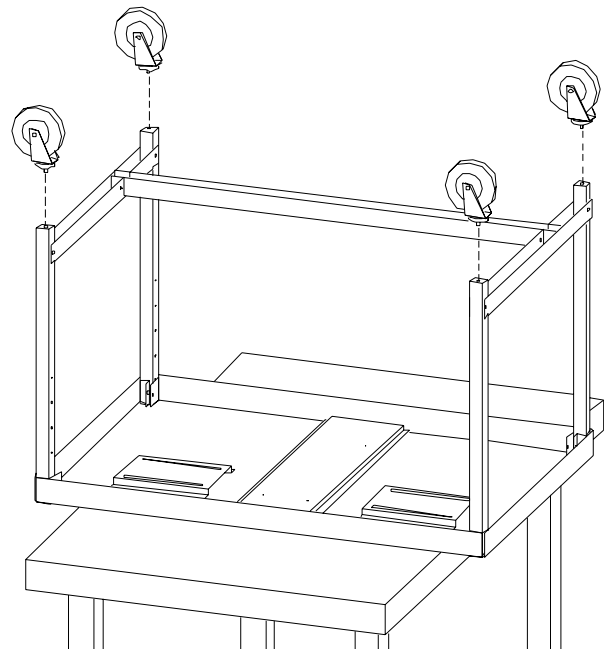

### STEP 5

Insert each caster into the legs. If casters do not insert easily, use a rubber mallet to tap each caster in place. Make sure casters are **SECURELY** seated into the legs before stand unit upright.

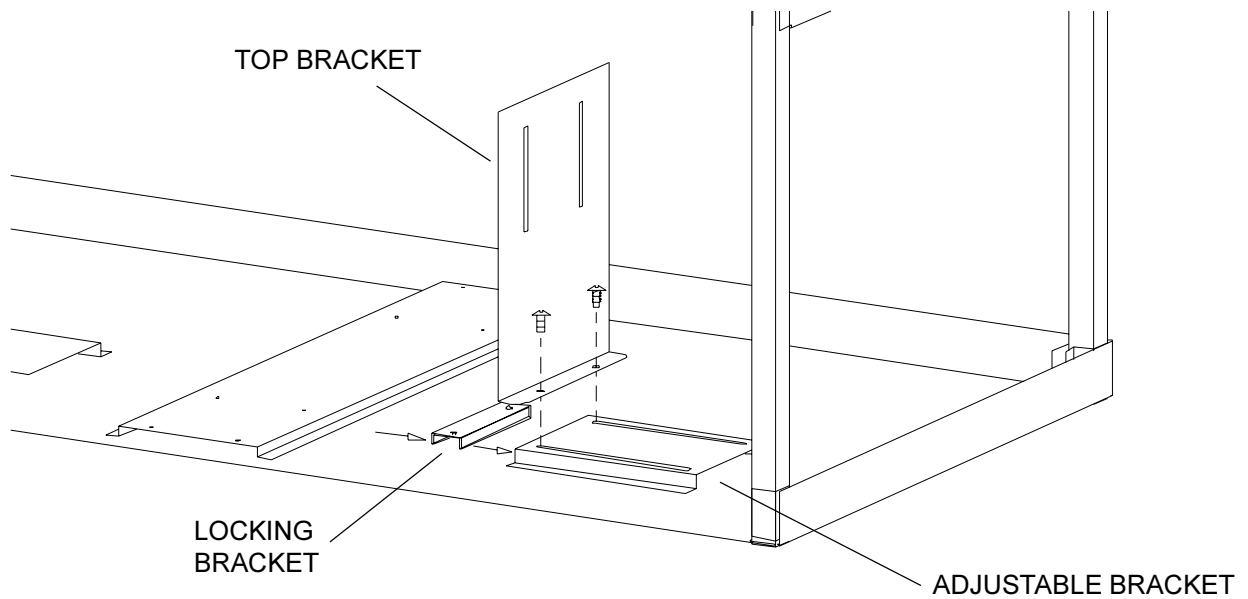

### STEP 6

Slide the locking bracket into the adjustable bracket on the top shelf as shown. Align the top bracket with both the adjustable and locking bracket. Secure in place with screws (FF). To adjust top bracket, just loosen screws slide bracket forward or back ward and then tighten screws in place. **NOTE:** The locking and top bracket can be mounted to either the right or left side of the top shelf.

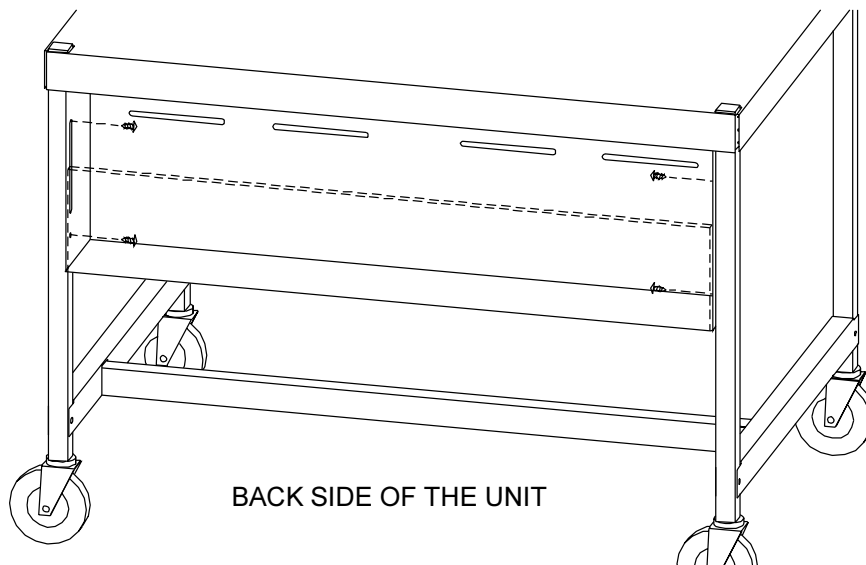
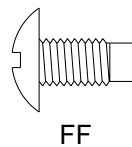

### STEP 7

Stand unit upright and position the wire tray between the rear legs. Starting at the top, secure in place using screws (CC) as shown.

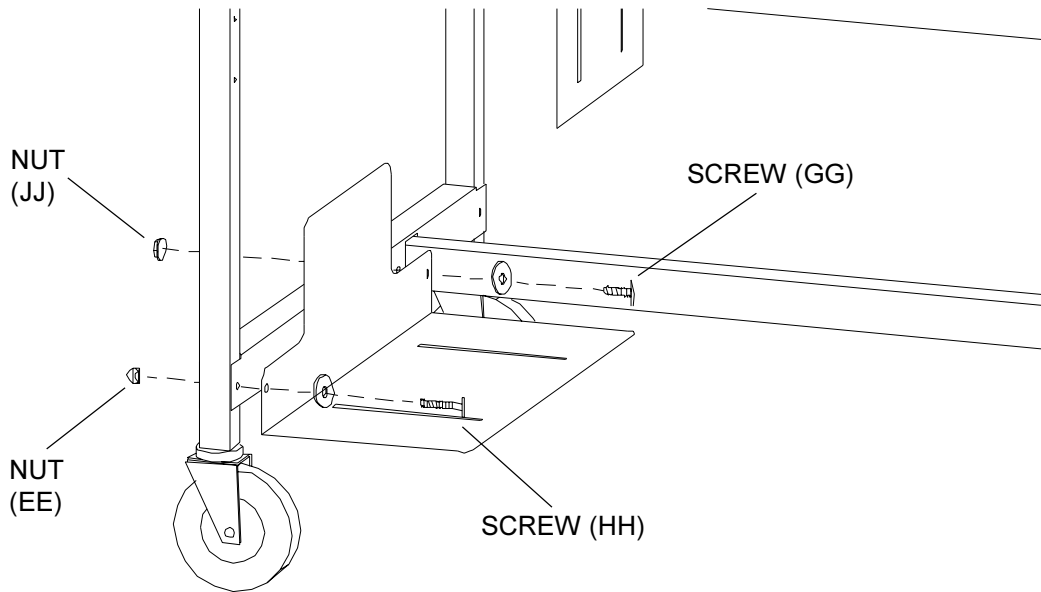

### STEP 8

Attach the side bracket to the H-frame with screw (GG), screws (HH), washers (II), nut (EE) and nut (JJ) as shown.

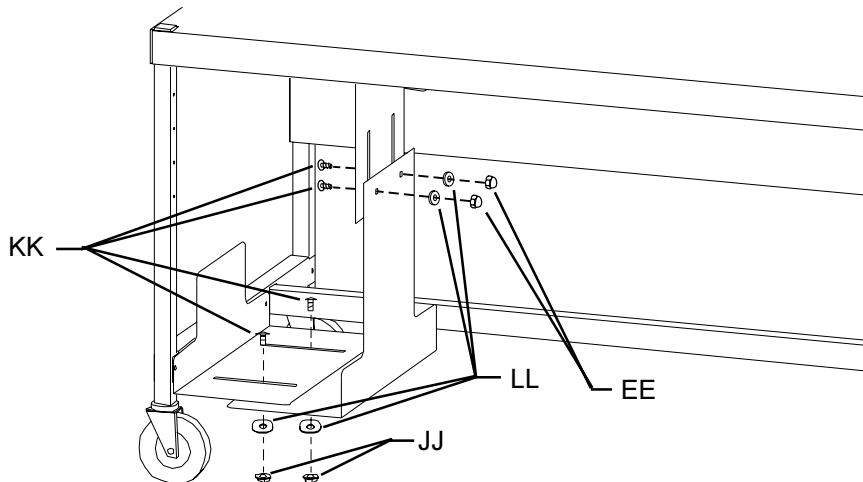
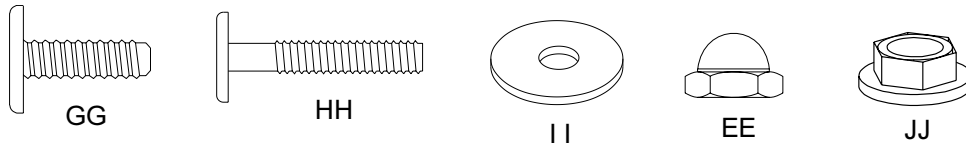

### STEP 9

Attach the bottom bracket to the side and top brackets with bolts (KK), washers (LL) and nuts (EE) and (JJ) as shown. **NOTE:** To make any adjustments to the height or width of the top or bottom brackets, just loosen hardware, slide bracket in desired direction and the retighten hardware in place.

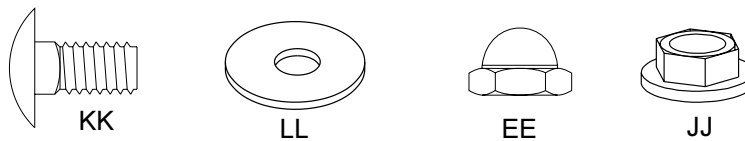

**Bretford**  
 11000 Seymour Avenue  
 Franklin Park, IL 60131  
 TEL: 847.678.2545  
 800.521.9614  
 FAX: 847.678.0852  
 800.343.1779

**Bretford Ltd.**  
 Technology House  
 7 Lake End Court, Taplow  
 Bucks SL6 0JQ England  
 TEL: 01628 603558  
 FAX: 01628 604923

Part #031-2963  
 Rev. 03.30.00 YP