

## LEGACY COLLECTION FILLER PANELS

### Assembly Instructions

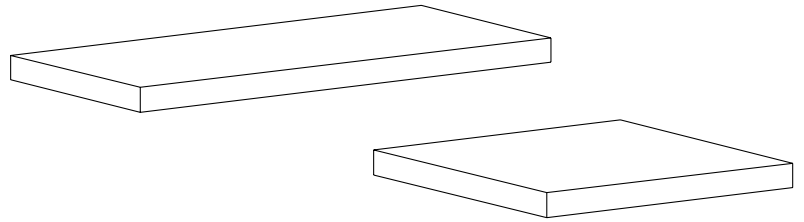

#### PARTS LIST

Qty	Description
1	Wood Filler Panel 14 1/4" x 27 3/8" <b>OR</b> 19 5/8" x 38 3/16"
2	Wood Mounting Pegs
12	#8 x 1 1/4" Screws

MEASURE THE OPENING WHERE YOUR FILLER TOP IS NEEDED. USE A CIRCULAR SAW WITH A GOOD QUALITY CARBIDE TIPPED SAW BLADE. PUT THE GOOD FACE DOWN AND CUT FROM OPPOSITE SIDE. **BE VERY CAREFUL WHEN CUTTING YOUR FILLER TOP SO YOU DO NOT CHIP THE SURFACE.** MAKE SURE TO MEASURE THE FILLER TOP PROPERLY AND CUT A STRAIGHT LINE. ONCE YOUR FILLER TOP IS CUT, USE THE INSTRUCTIONS BELOW THAT APPLY TO YOUR APPLICATION.

#### END PANEL TO END PANEL APPLICATION

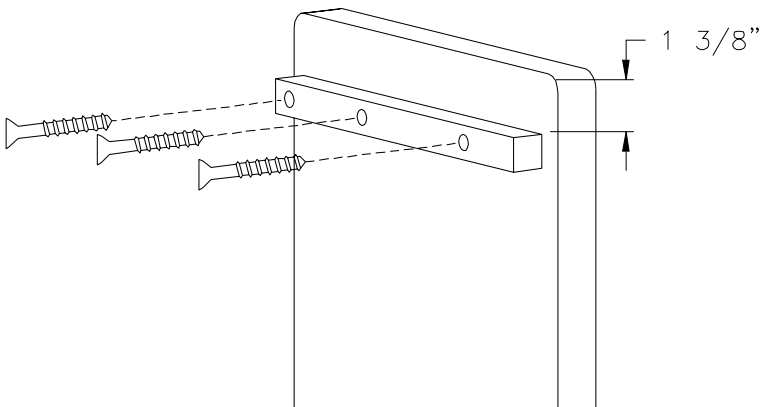

#### STEP 1

Center each peg on the side panel 1 3/8" below the top edge as shown. Using screws (AA) given secure the peg to both side panels as shown.

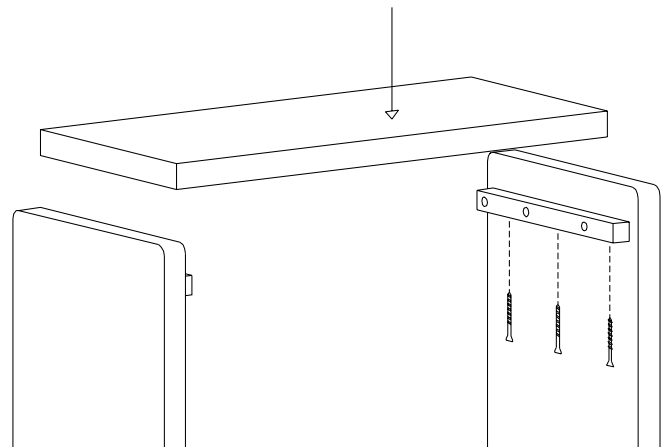

#### STEP 2

Space the side panels at an appropriate distance to accommodate the size of the filler. Set filler onto pegs and secure with screws from underneath as shown. Now slide joining side panel flush to filler and continue installing the rest of your shelving units.

## END PANEL TO WALL APPLICATION

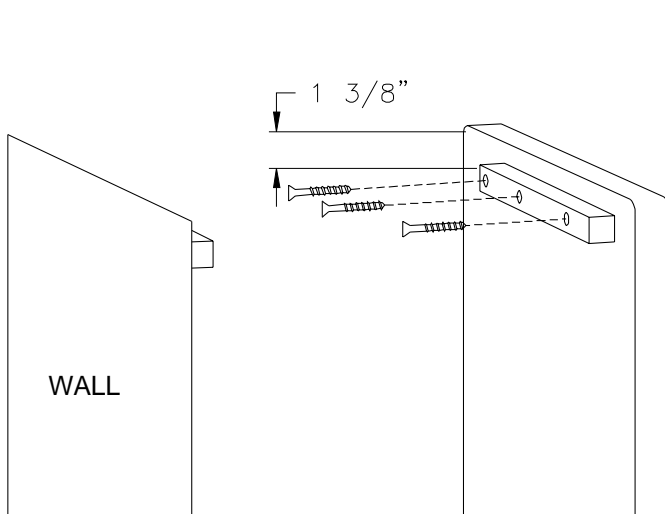

### STEP 1

Center 1 peg on the end panel 1 3/8" below the top edge as shown. Using screws (AA) given secure the peg to end panel as shown. Install the other peg properly to the opposite wall.

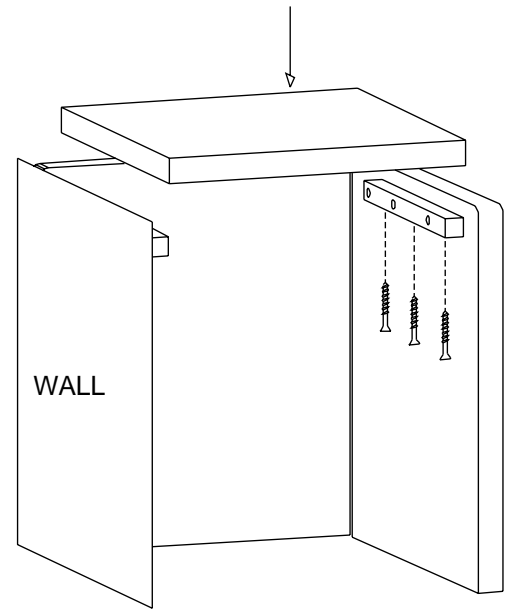

### STEP 2

Space the end panels at an appropriate distance to accommodate the size of the filler. Set filler onto pegs and secure with screws from underneath as shown. Now slide joining end panel flush to filler and continue installing the rest of your shelving units.

**Bretford**  
11000 Seymour Avenue  
Franklin Park, IL 60131  
TEL: 847.678.2545  
800.521.9614  
FAX: 847.678.0852  
800.343.1779

**Bretford Ltd.**  
Technology House  
7 Lake End Court, Taplow  
Bucks SL6 0JQ England  
TEL: 01628 603558  
FAX: 01628 604923

[www.bretford.com](http://www.bretford.com)

Part #AI1024  
Rev. 08.04.98 CH