

FWCSG100 FWCSG200 FWCSG300

GROOVE ADJUST TABLES - MINI MIDI & MAXI

Assembly Instructions



Hardware List

| Ref. | Qty. | Part No. | Description |
|------|-------|-----------|---|
| AA | 3/4 | 0040-2008 | M8 x 20 Socket Cap Screws (3) for G100 & G200 (4) for G300 |
| BB | 18/24 | 0040-8200 | 1/4 x 7/8 Phillips Mod-Truss Screws (18) for G100 & G200 (24) for G300 |

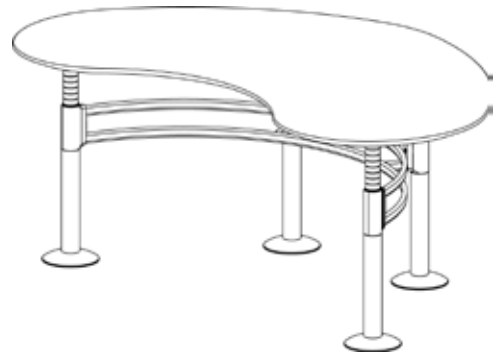

MODELS FWCSG100 (MINI) & FWCSG200 (MIDI)

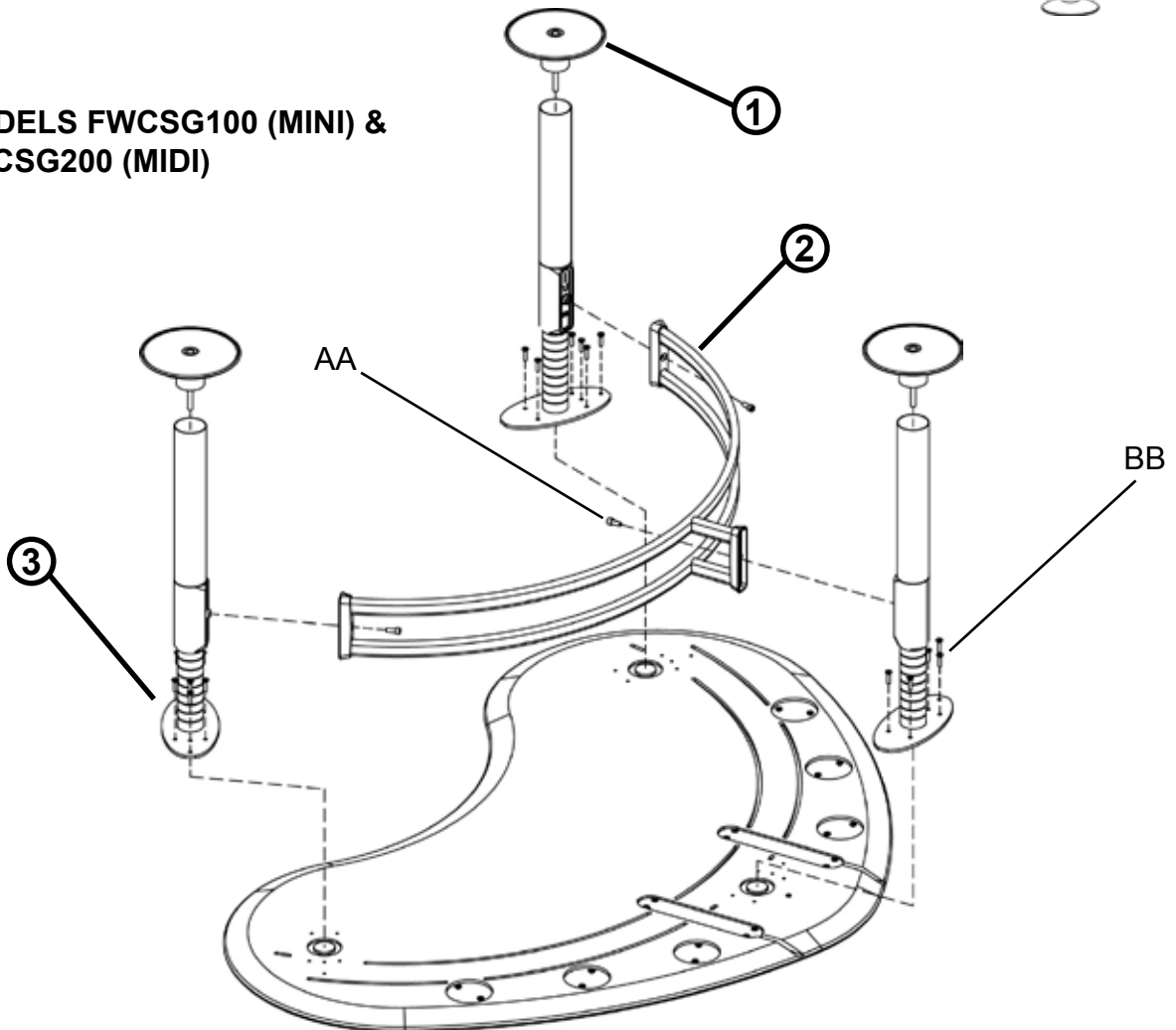

- 1) Twist a pod base onto the bottom of each leg.
- 2) **LOOSELY** attach chassis rail to leg with screws (AA).
- 3) Attach each leg to wood top with screws (BB). Then tighten screws (AA).

MODEL FWCSG300 (MAXI)

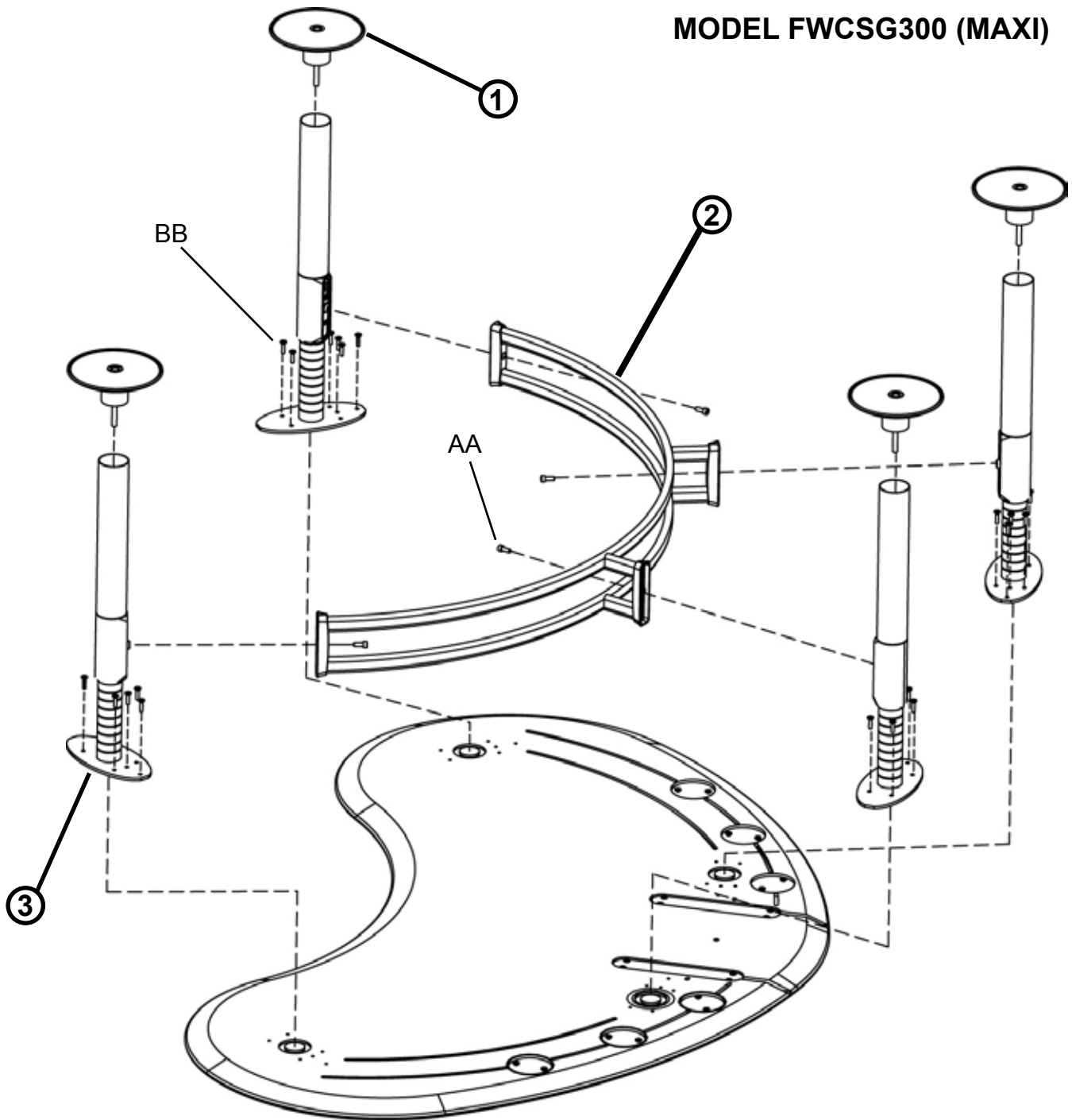

- 1) Twist a pod base onto the bottom of each leg.
- 2) **LOOSELY** attach chassis rail to leg with screws (AA).
- 3) Attach each leg to wood top with screws (BB). Then tighten screws (AA).

ADJUSTING TABLE HEIGHT

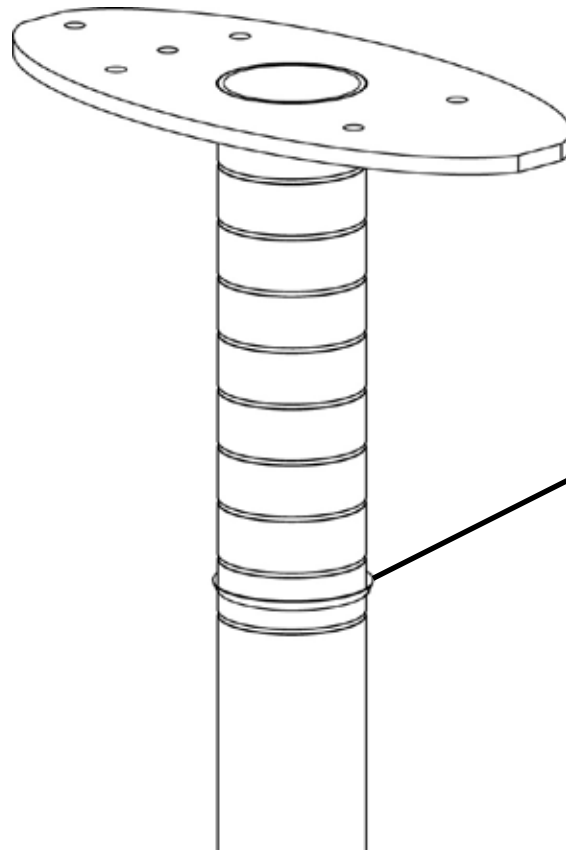

Slide ring into desired height groove. Then lower leg down onto ring's new position.

Adjusting the height of your table is a simple process; however Bretford recommends this as a “technician adjustment” process that is easiest if completed by more than one person.

- 1) Lift table top to pull the upper section of the leg from the lower section.
(This exposes the split ring)
- 2) Relocate the ring to a desired groove position on all legs.
- 3) Lower table top back into position.

Bretford
11000 Seymour Avenue
Franklin Park, IL 60131
TEL: 847.678.2545
800.521.9614
FAX: 847.678.0852
800.343.1779

Bretford Ltd.
2 Etongate
110 Windsor Road, Slough
Berkshire SL1 2JA England
TEL: 011 44 17 5353 9955
FAX: 011 44 17 5353 9478

www.bretford.com

Part # 031-7339
Rev. 02.20.07 CZ