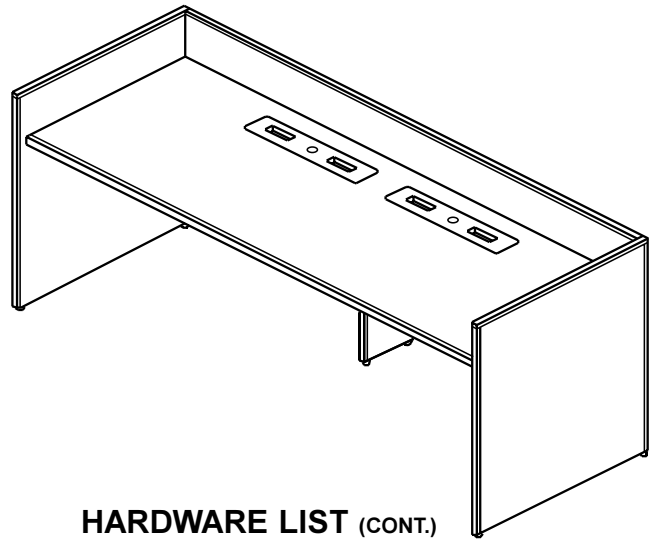




**BRETFORD**

# LSTCC STARTER TECHNOLOGY CARREL SINGLE SIDED

## Assembly Instructions



### PARTS LIST

Qty.	Description
1	Work Surface
1	Wire Bin Assembly
2	End Panel
1	Back Panel
2	Wire Access Door (1 required on: 36, 48 & 60 widths)
1	Support Leg (required on: 72 & 96 widths only)

### HARDWARE LIST

Qty.	Description
2	End Panel Bracket
20	1/4-20 x 1/2" Phillips Pan Head Screw (18 required on: 36, 48 & 60 widths)
6	Glides (4 required on: 36, 48 & 60 widths)
14	#10 x 5/8" Type 'AB' Truss Head Screw (10 required on: 72 & 60 widths and 6 required on: 36 & 48 widths)

### HARDWARE LIST (CONT.)

Qty.	Description
4	#10-32 X 1/2" Knurled Finger Screw (2 required on: 36, 48 & 60 widths)
4	Plastic Washer (2 required on: 36, 48 & 60 widths)
8	#6 x 1/4" Type 'B' Phillips Pan Head Screw (4 required on: 36, 48 & 60 widths)
(*)	MOD-EEZ Pins <u>39 heights only:</u> (14) 72 & 96 widths (12) 36, 48 & 60 widths <u>25, 26 1/2, 29 &amp; 32 heights:</u> (10) 72 & 96 widths (8) 36, 48 & 60 widths
4	Grommet (2 required on: 36, 48 & 60 widths)
1	Support Leg Bracket (required on: 72 & 96 widths only)
2	Lock Assembly Pack (1 required on: 36, 48 & 60 widths)
2	Cam - Lock (1 required on: 36, 48 & 60 widths)

### End Panel

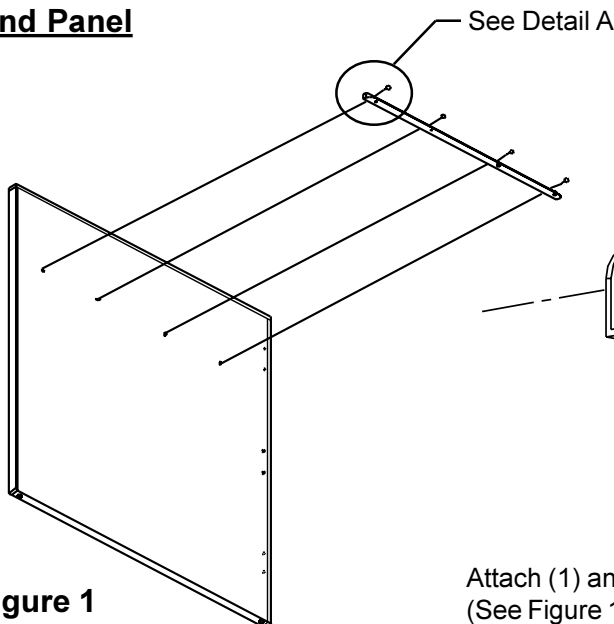
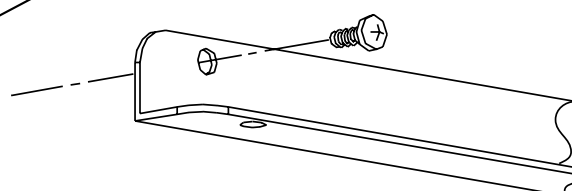
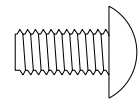


Figure 1



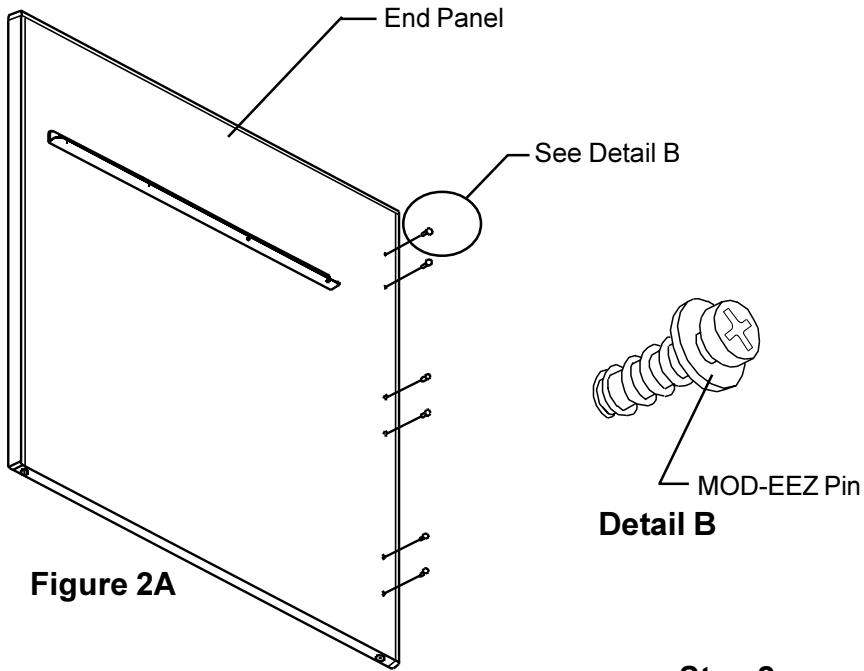
Detail A



1/4-20 x 1/2" Phillips  
Round Head Screw

### Step 1

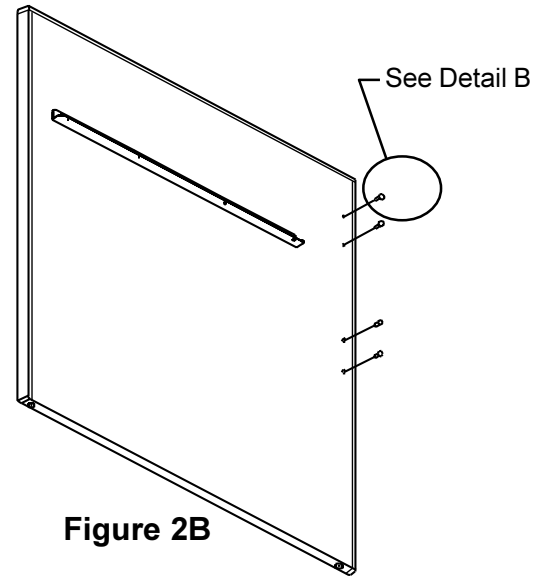
Attach (1) angle bracket to each end panel using 1/4-20 x 1/2" screws  
(See Figure 1).



**Figure 2A**

**Step 2**

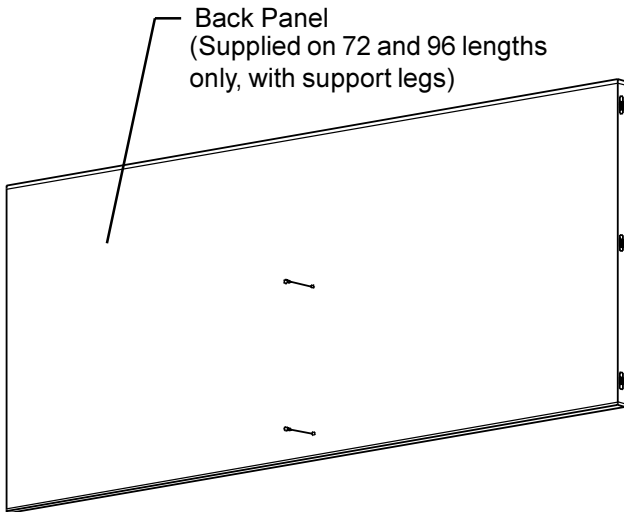
Install (6) MOD-EEZ Pins on end panels required on 72, 96 lengths and 39 heights (See Figure 2A).



**Figure 2B**

Install (4) MOD-EEZ Pins on end panels required on 36, 48 and 60 lengths except at 39 heights (See Figure 2B).

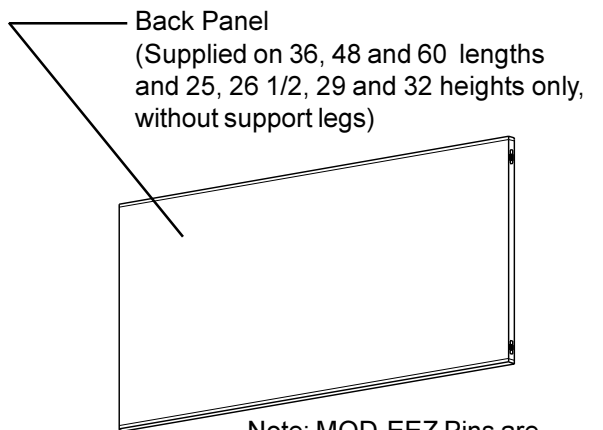
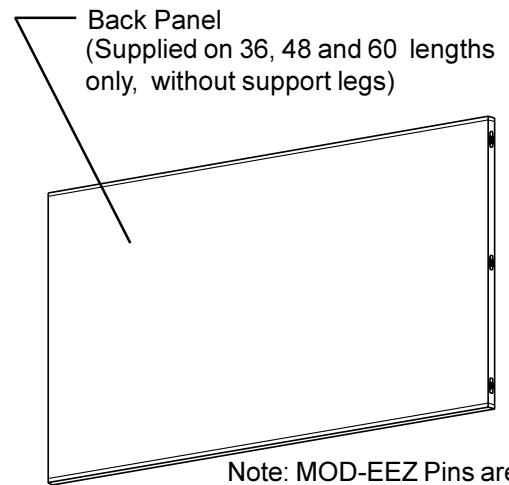
**Back Panel**

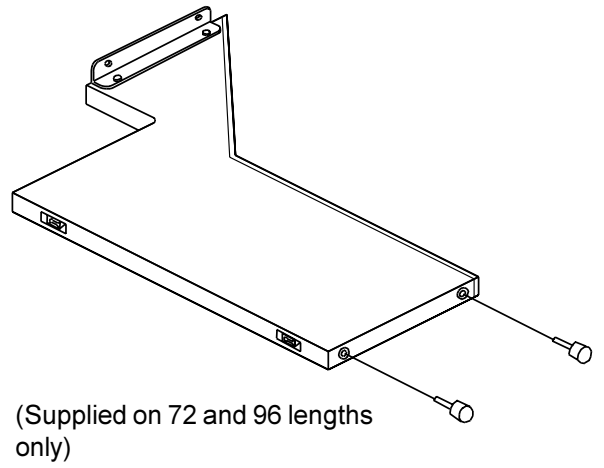
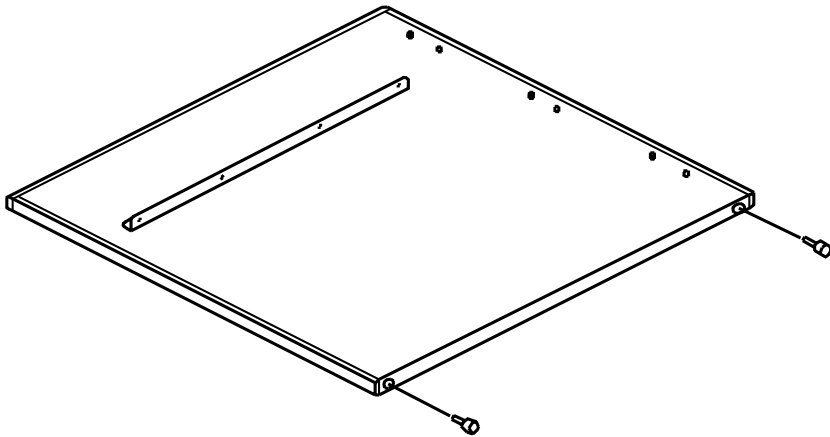
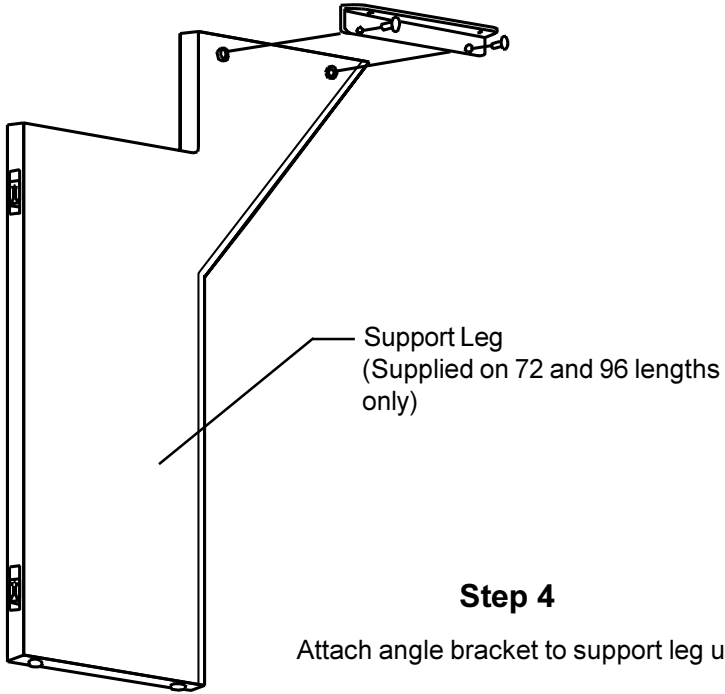


**Figure 3**

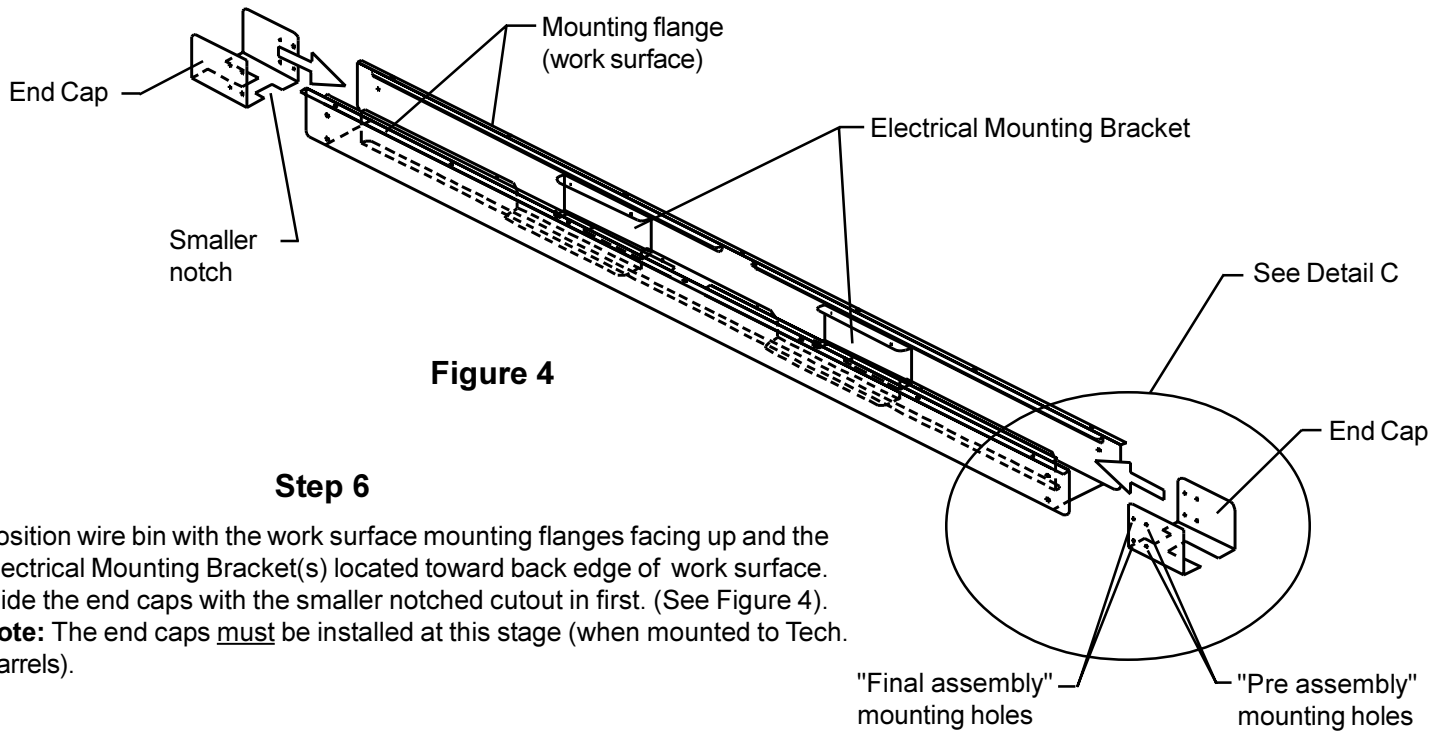
**Step 3**

Install (2) MOD-EEZ Pins on back panel (See Figure 3).





**Step 5**  
Install leg glides to both end panels and the leg support.

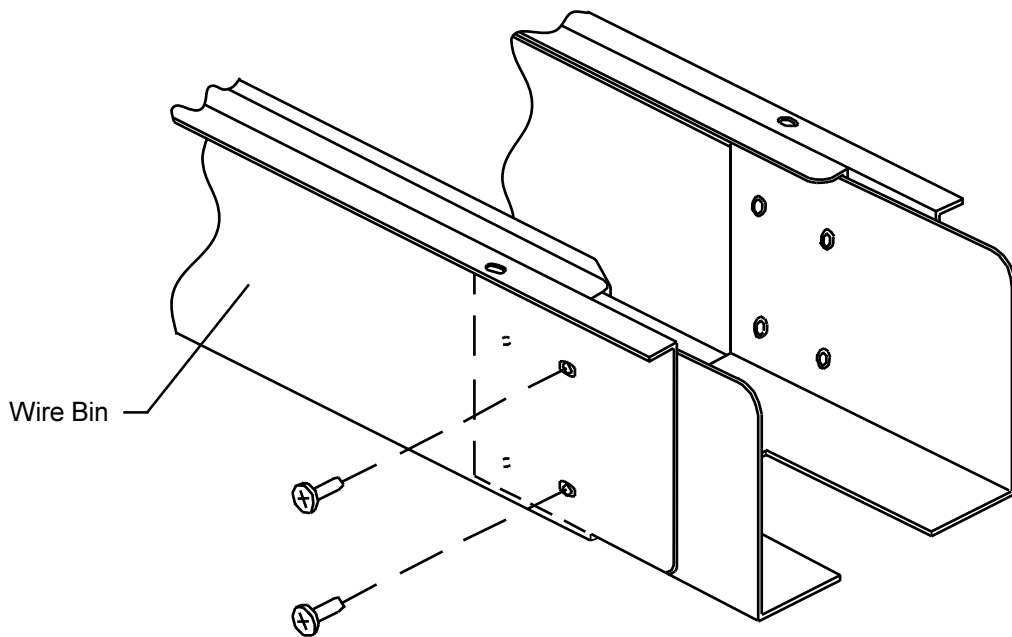


**Figure 4**

**Step 6**

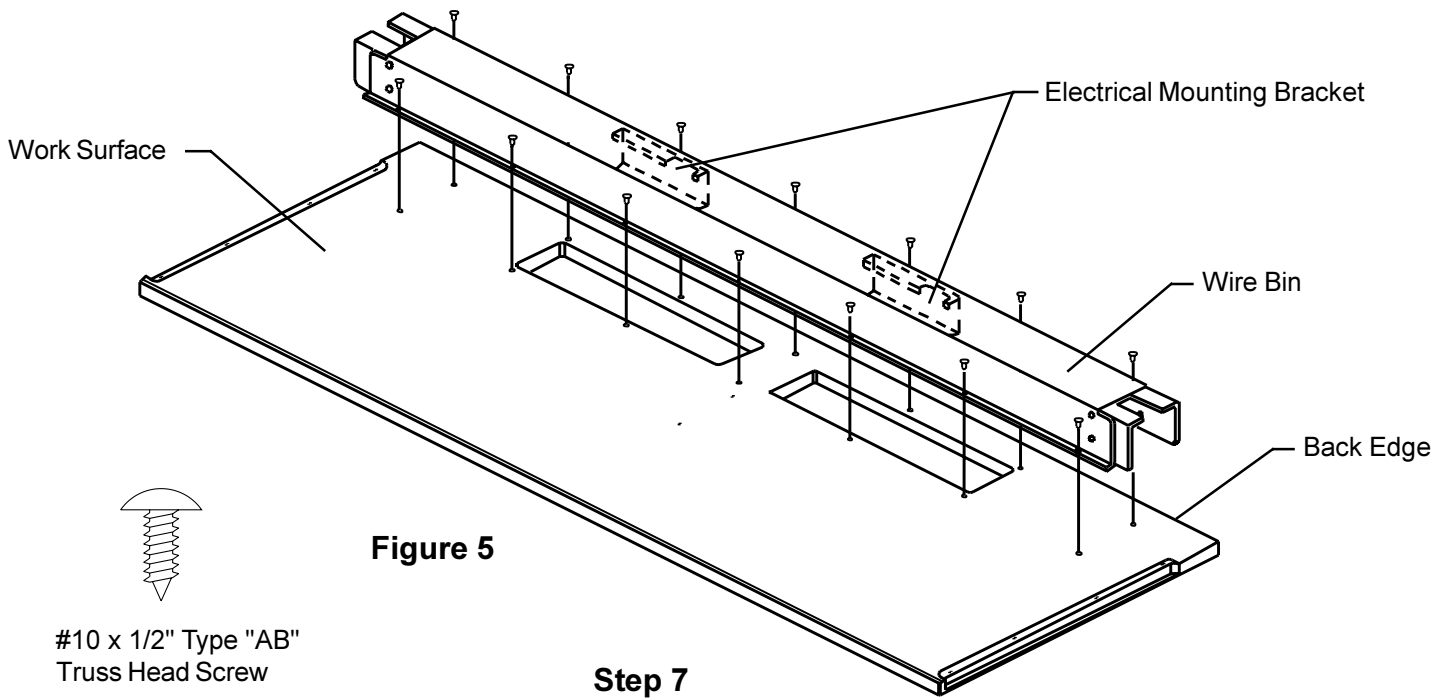
Position wire bin with the work surface mounting flanges facing up and the Electrical Mounting Bracket(s) located toward back edge of work surface. Slide the end caps with the smaller notched cutout in first. (See Figure 4).

**Note:** The end caps must be installed at this stage (when mounted to Tech. Carrels).

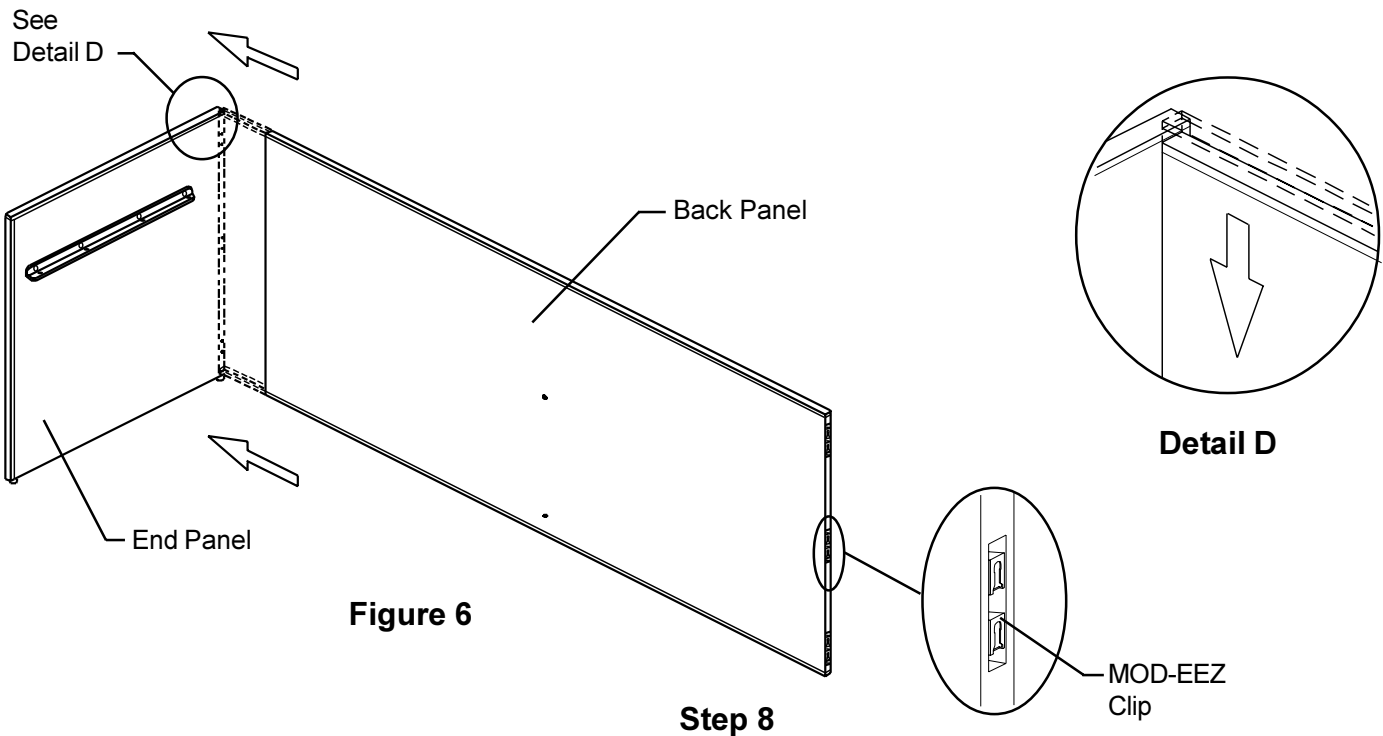


**Detail C**

Temporarily install both end caps with (2) each 1/4-20 screws (snug fit-not tight) into the "pre assembly" mounting holes (See Figure 4).

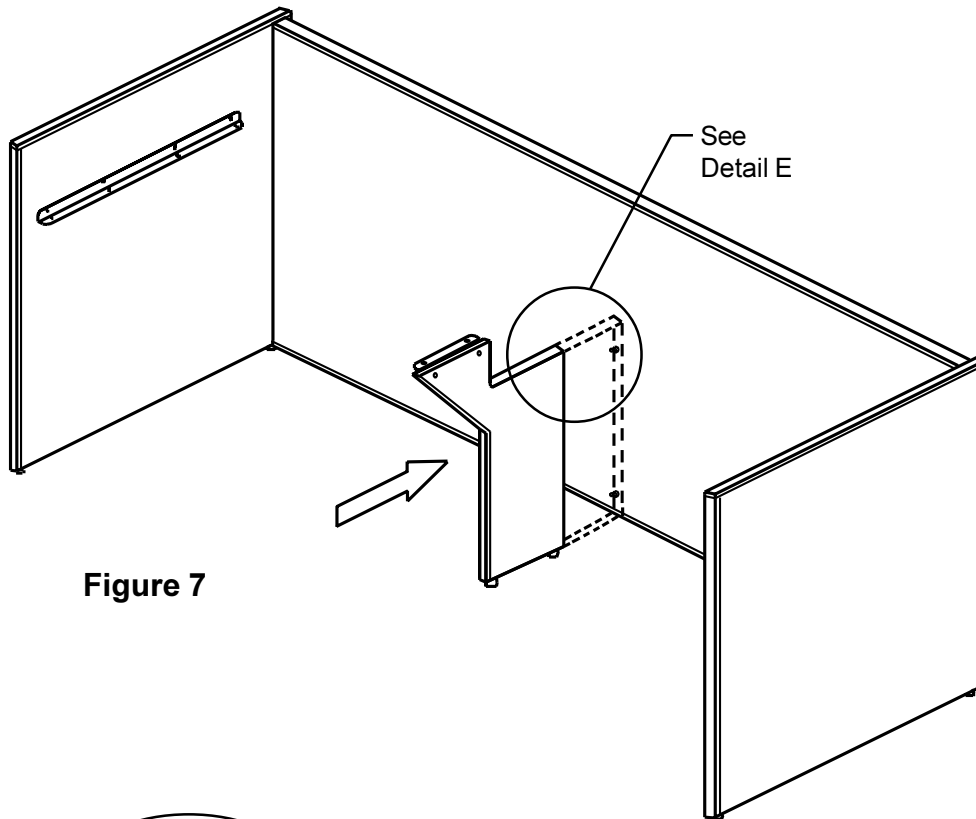


Position the work surface with the mounting holes facing up, taking care not to scratch the work surface face (top surface). Align the mounting holes of the wire bin with the mounting holes on the work surface. **Note:** Make sure that the Electrical Mounting Bracket(s) are toward the back edge of the work surface (See Figure 5). Secure the wire bin with #10 x 1/2" screws.

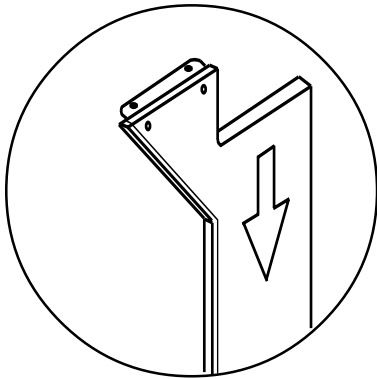


Position the back panel with the open ends of the MOD-EEZ clip facing down. Slide the open end of the clips onto the end panel mounting pins (See Figure 6). Push down on the back panel with firm pressure to "lock" the back panel with the end panel (See Detail D). Repeat Step 8 to mount the other end panel.

**Skip to "Step 10" if your carrel is  
other than a 72 or 90 length.**



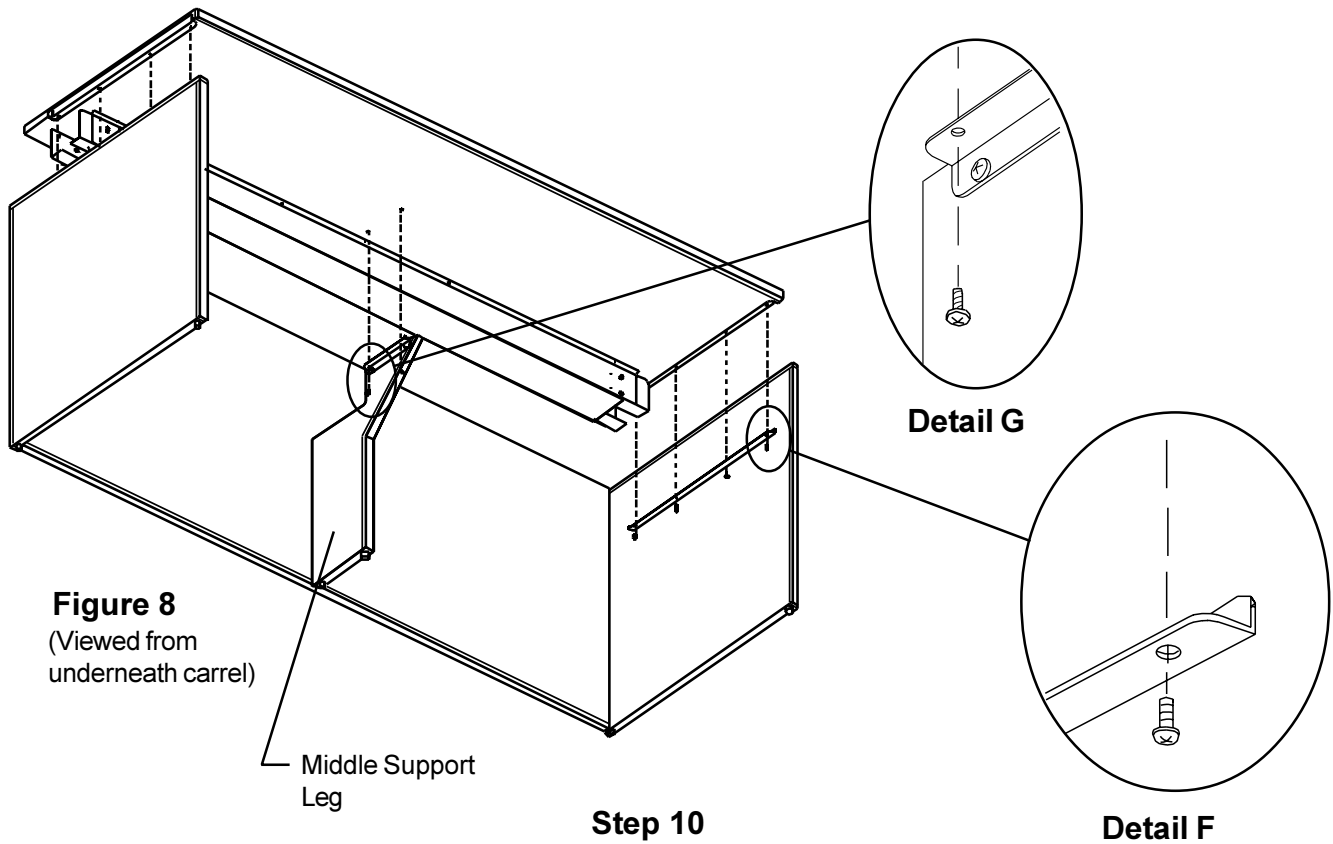
**Figure 7**



**Detail E**

### **Step 9**

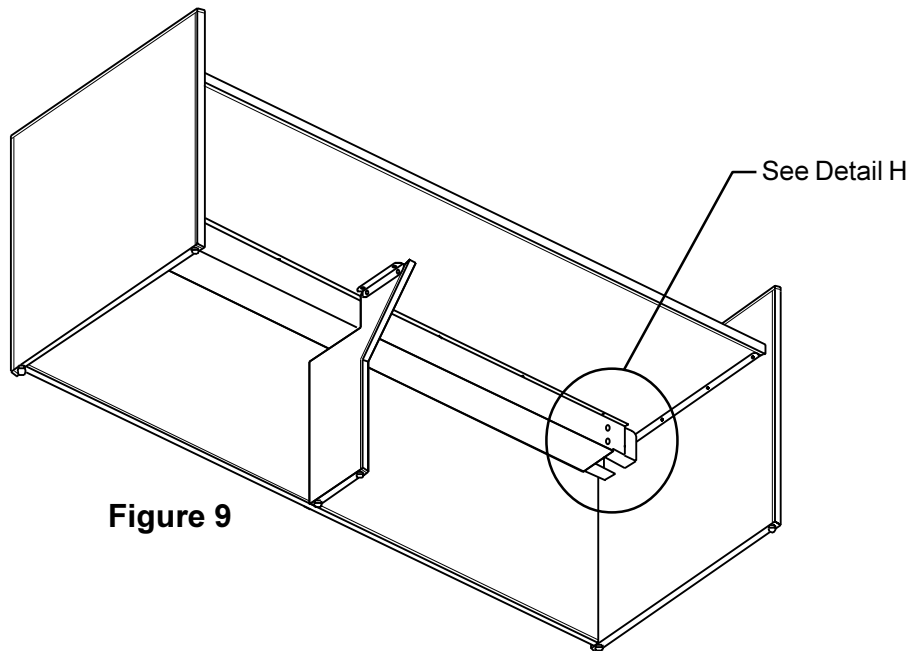
Position support leg with the open ends of the MOD-EEZ clip facing down. Slide the open end of the clips onto the back panel mounting pins (See Figure 7). Push down on the support leg with firm pressure to "lock" the support leg with the back panel (See Detail E).



**Step 10**

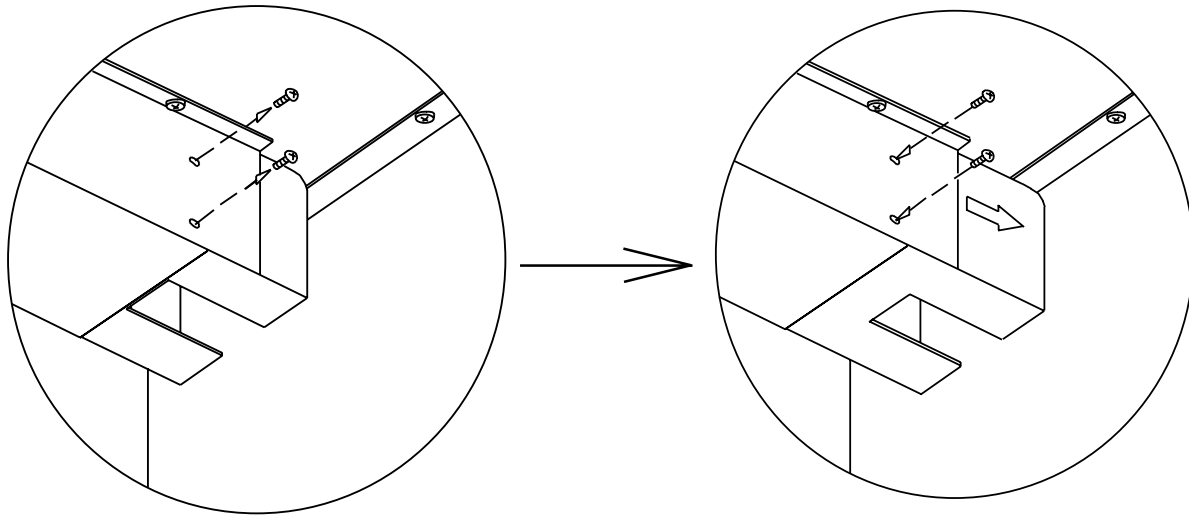
**Note:** The following step will require assistance to assemble.

Position the work surface with wire bin facing down. Slide work surface onto the end panel angle brackets (See Figure 8). **Note: The work surface must be secured at this point.** Loosely install 1/4-20 x 1/2" screws through end panel brackets into the work surface mounting holes for proper alignment, then tighten all screws (See Detail F). If your carrel has a middle support leg, fasten it with 1/4-20 x 1/2" screws (See Detail G).

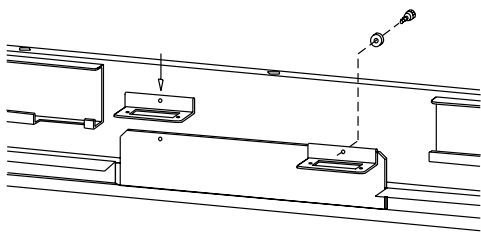


**Step 11**

From underneath the carrel (Figure 9), loosen and remove the (2) 1/4-20 screws from the end cap "pre assembly" mounting holes on both ends of the wire bin. Slide the end caps outward to the "final assembly" mounting holes (Ref: Figure 4) and reinstall the (2) 1/4-20 screws to secure each end cap (See Detail H).

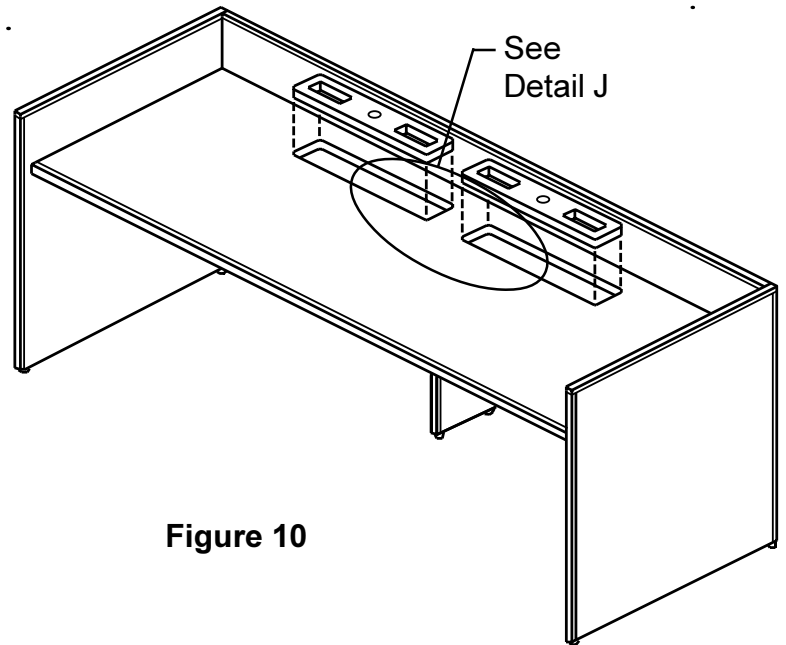


**Detail H**



**Detail J**

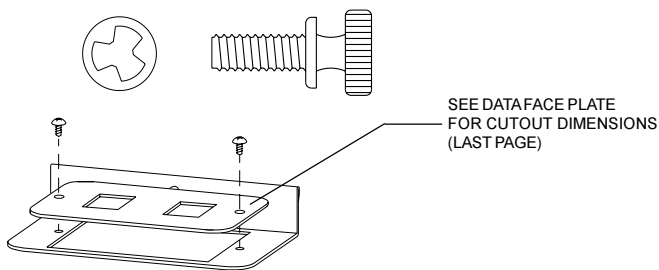
Showing Wire Bin detail for installation of Data Clip. Slide data clip onto wire bin flange, lining up the mounting holes. Install plastic washer and thumb screw as shown. (Front flange of the wire bin has been removed for clarity.)



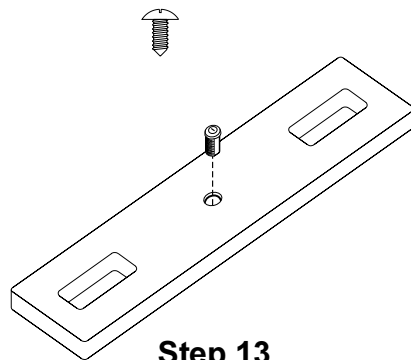
**Figure 10**

**Step 12**

Install the Wire Access Door(s) in work surface top (See Figure 10). Steps 13 thru 15 are for assembling lock onto wire access door(s).

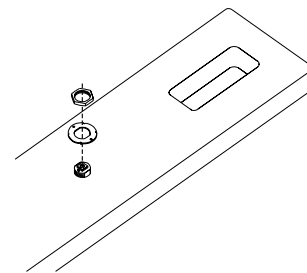


Install appropriate data clip cover to the data clip using #4 x 1/4" self tapping screw.



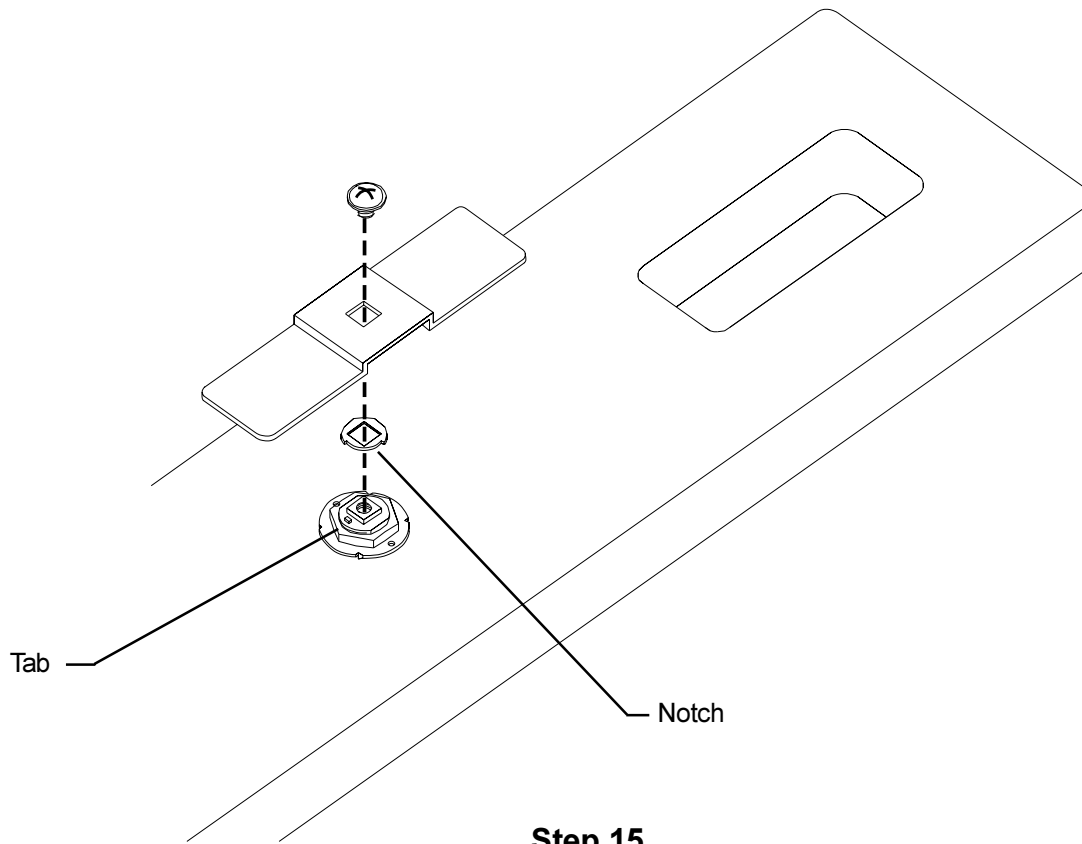
**Step 13**

Install cylinder lock through the counter bored hole with the flats of the cylinder parallel with the front/rear edges.



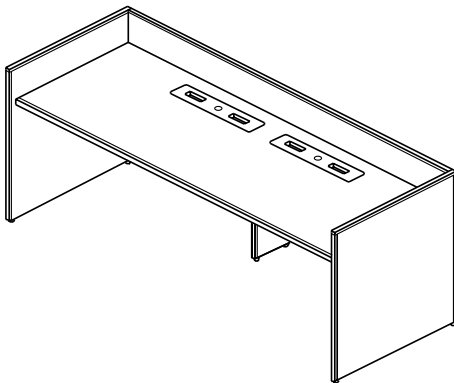
**Step 14**

Flip the door panel over and place the cylinder washer (with points facing down) over lock cylinder. Secure lock nut onto cylinder lock and tighten.



### Step 15

Place the washer (with 90 degree stop notch) onto the cylinder lock square post as shown. Attach the locking cam onto lock square post. Insert the screw into threaded end of square post and tighten.



After final positioning of the carrel is set, it might be necessary level out the assembly by turning the levelers clockwise (downward) or counter clockwise (upward).

DATA FACE PLATE  
(Cutout dimensions)

**Bretford**  
11000 Seymour Avenue  
Franklin Park, IL 60131  
TEL: 847.678.2545  
800.521.9614  
FAX: 847.678.0852  
800.343.1779

**Bretford Ltd.**  
Technology House  
7 Lake End Court, Taplow  
Bucks SL6 0JQ England  
TEL: 01628 603558  
FAX: 01628 604923

[www.bretford.com](http://www.bretford.com)

Part #031-3182  
Rev. 07.01.05 CH