

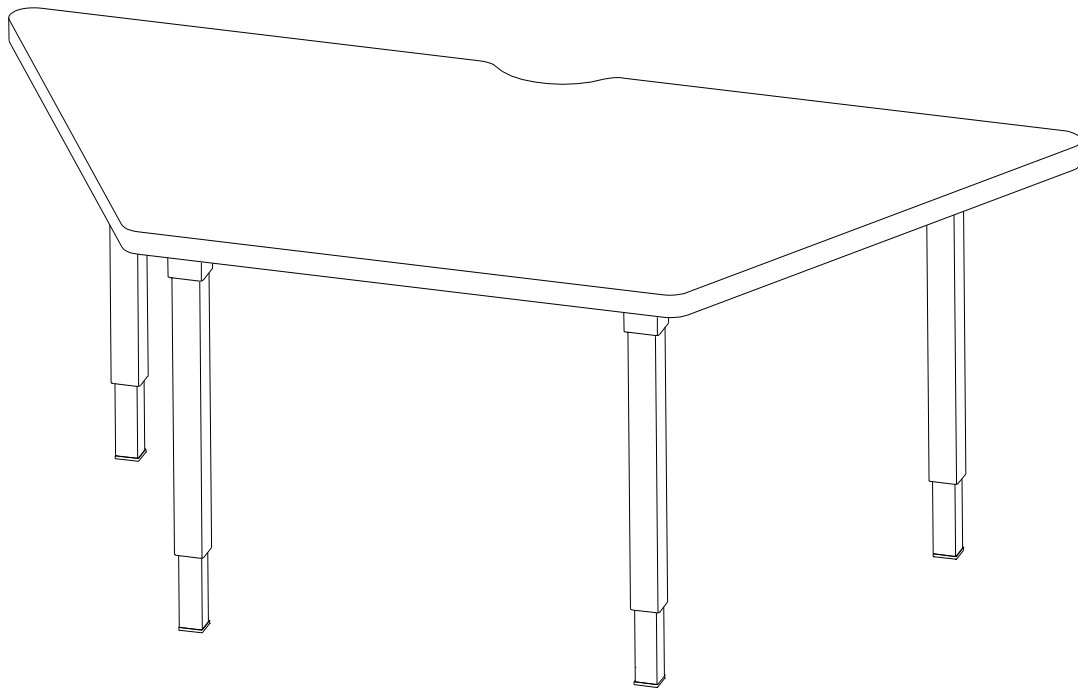

BRETFORD

TRAPEZOID SHELF (96 & 80)

Assembly Instructions



Parts List

<u>Qty.</u>	<u>Part No.</u>	<u>Description</u>
1	SA5915	80" Raiser
1	SA5916	96" Raiser
4	017-0713	Bottom Leg
4	017-0714	Top Leg

Hardware List

<u>Qty.</u>	<u>Part No.</u>	<u>Description</u>
12	030-0396	3/8-16 x 1/2" Set screw
2	030-0306	5/16 Washer
2	030-0401	5/16 x 1-1/2 Hex bolt

Tools Required

Philips Screwdriver
Allen Wrench
Adjustable Wrench
3/8 Drill

SAFETY WARNING

**Note: TWO PERSON
ASSEMBLY REQUIRED**

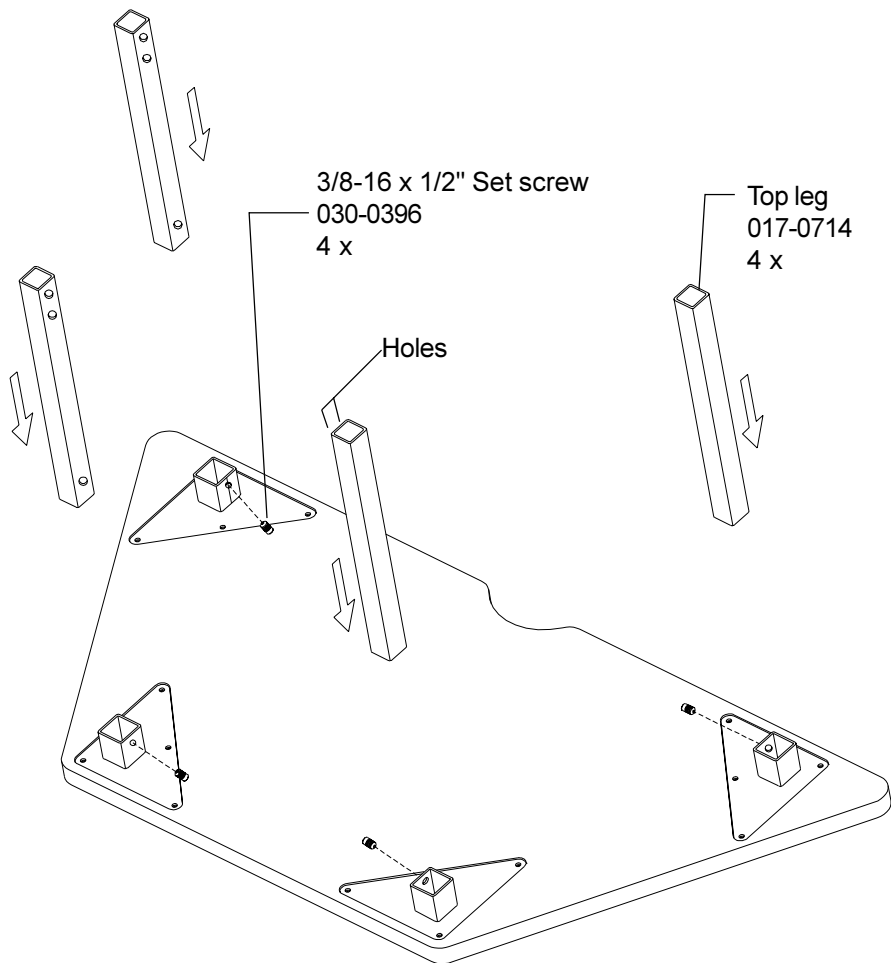

Step 1

Lay riser's wood top on a carpeted surface with holes facing upward. Insert the legs into corner tubes with holes facing as shown. Tighten legs with 3/8-16 x 1/2" Set screw (030-0396).

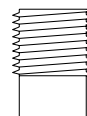

Step 2

Position holes in legs so that they face each other. Insert bottom legs into top legs. Set desired height and insert 3/8-16 x 1/2" (030-0396) Set screws into legs and tighten with Allen wrench. Stand the unit upright.

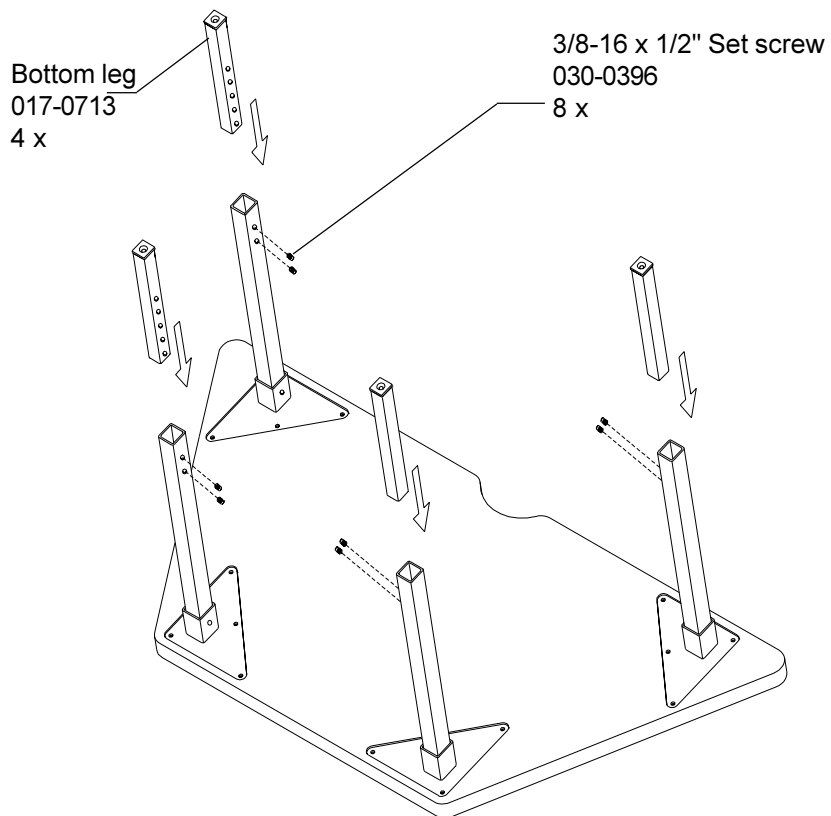

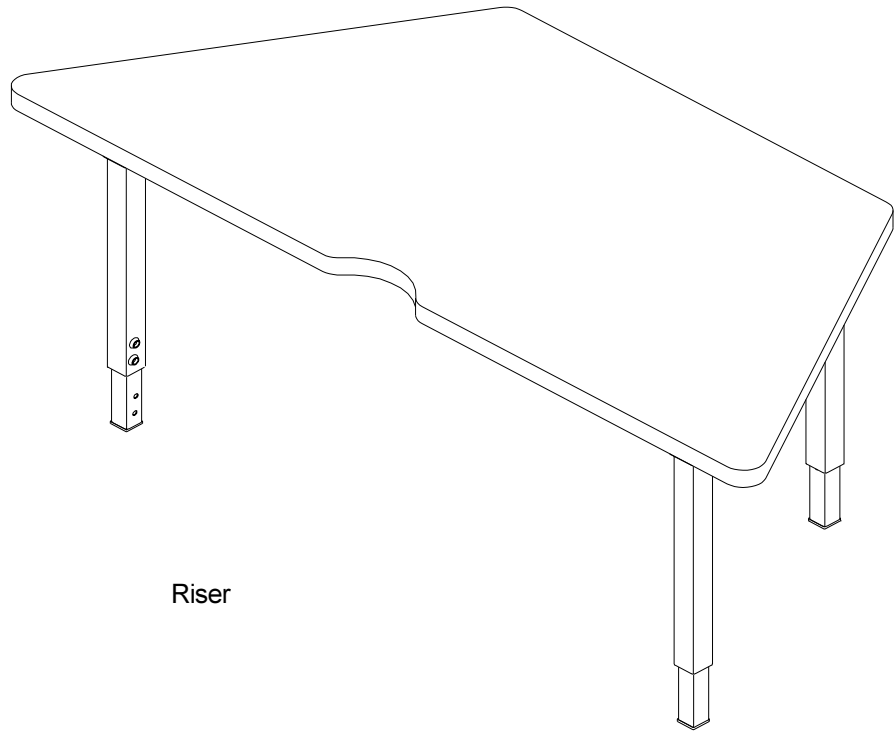

Riser

Worksurface

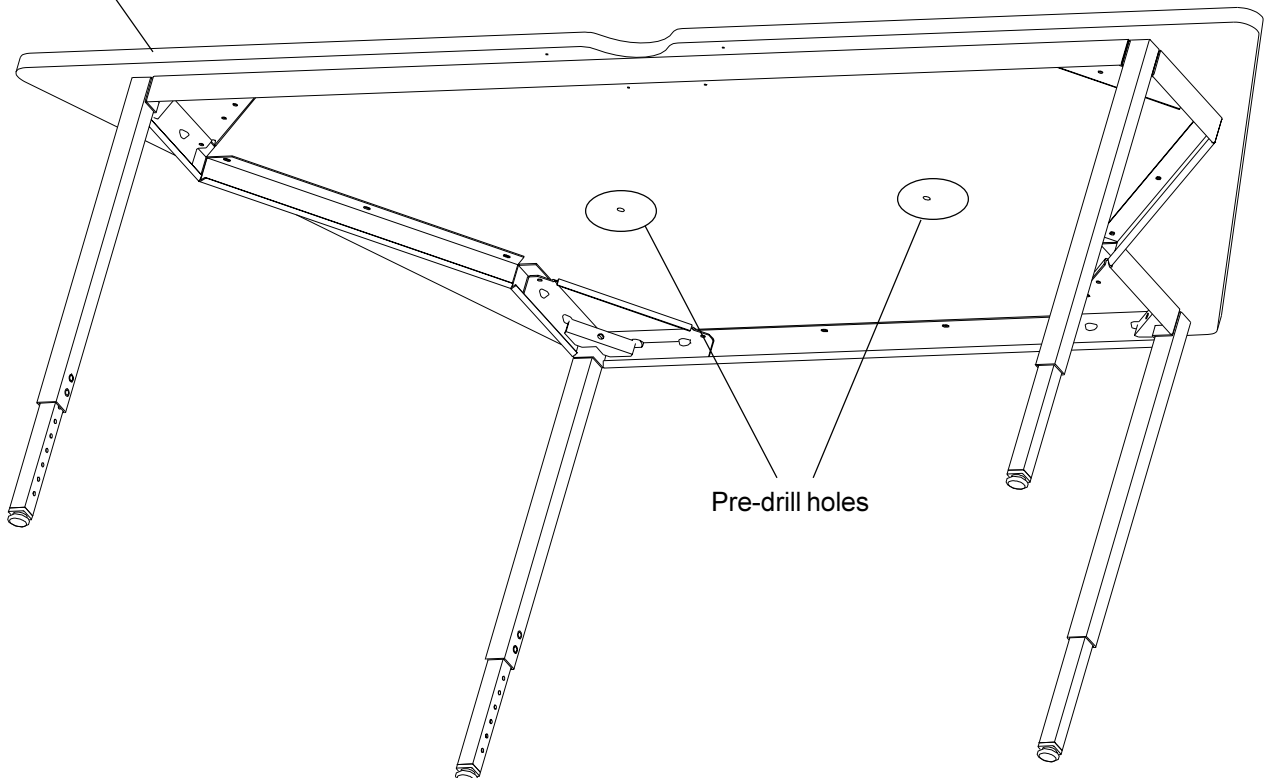

Pre-drill holes

Step 3

If you need to install riser on your table, drill thru pre-drill holes on the bottom of the table. Use 3/8 diameter drill to drill two holes thru.

Step 4

Position the riser over previously drilled holes. Attach the riser to the bottom surface using two 5/16 x 1-1/2 Hex bolts 030-0401 and two 5/16 Washers 030-0306 as shown.

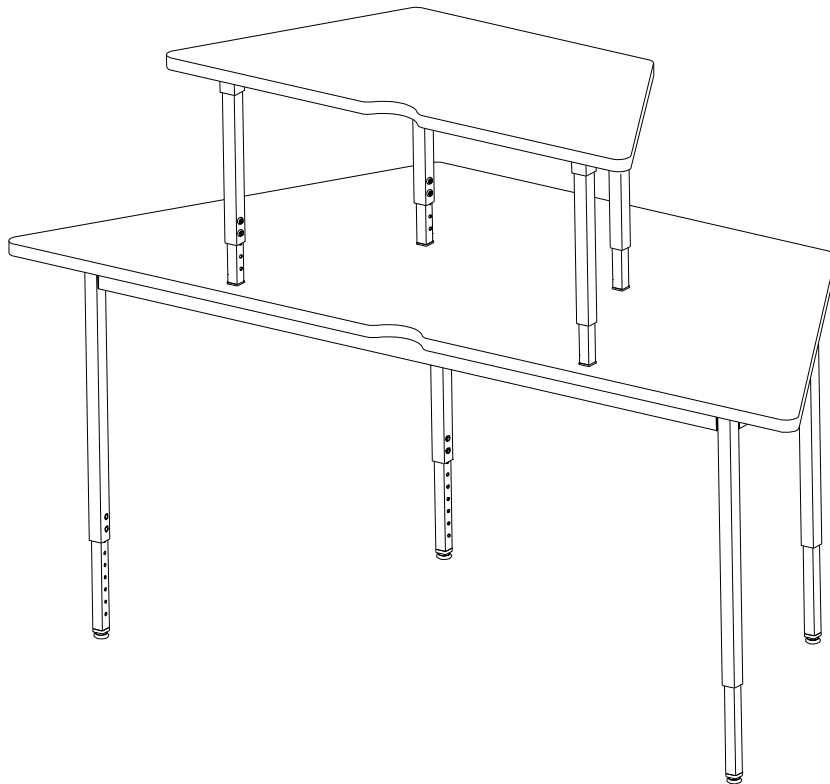
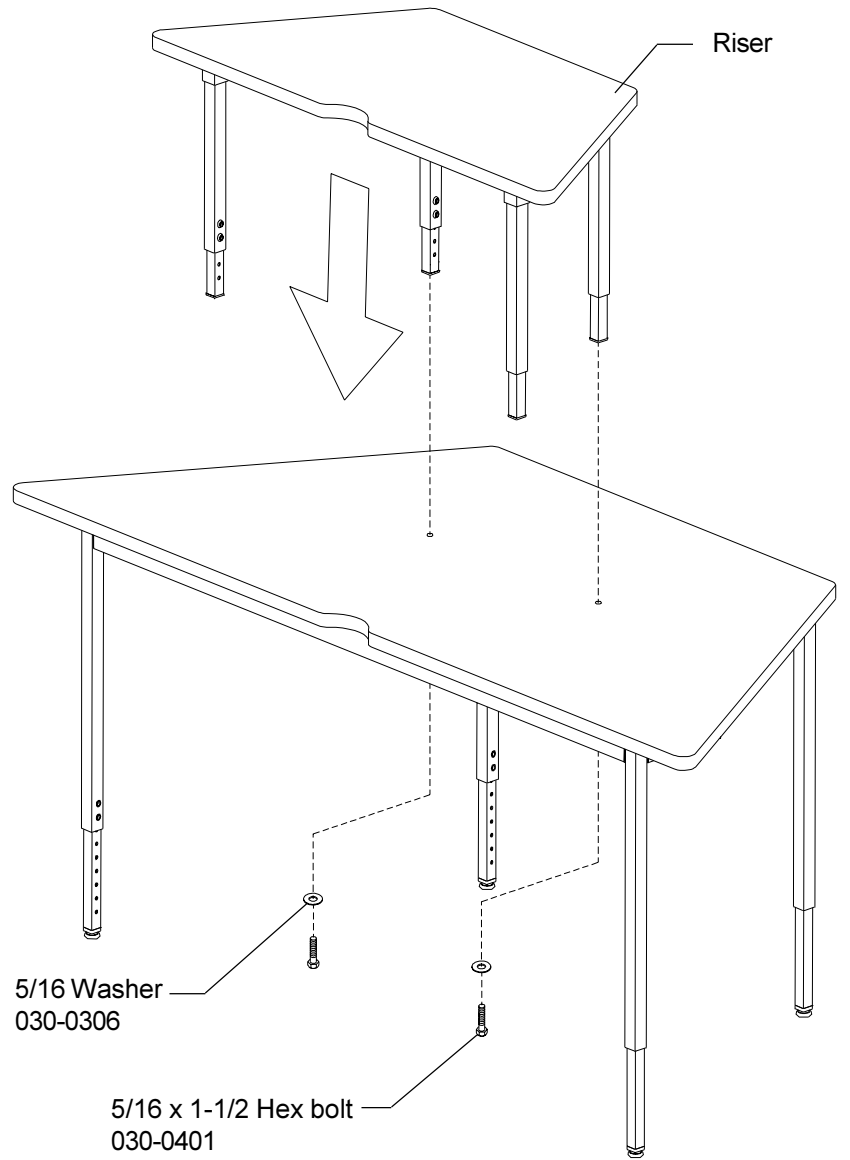

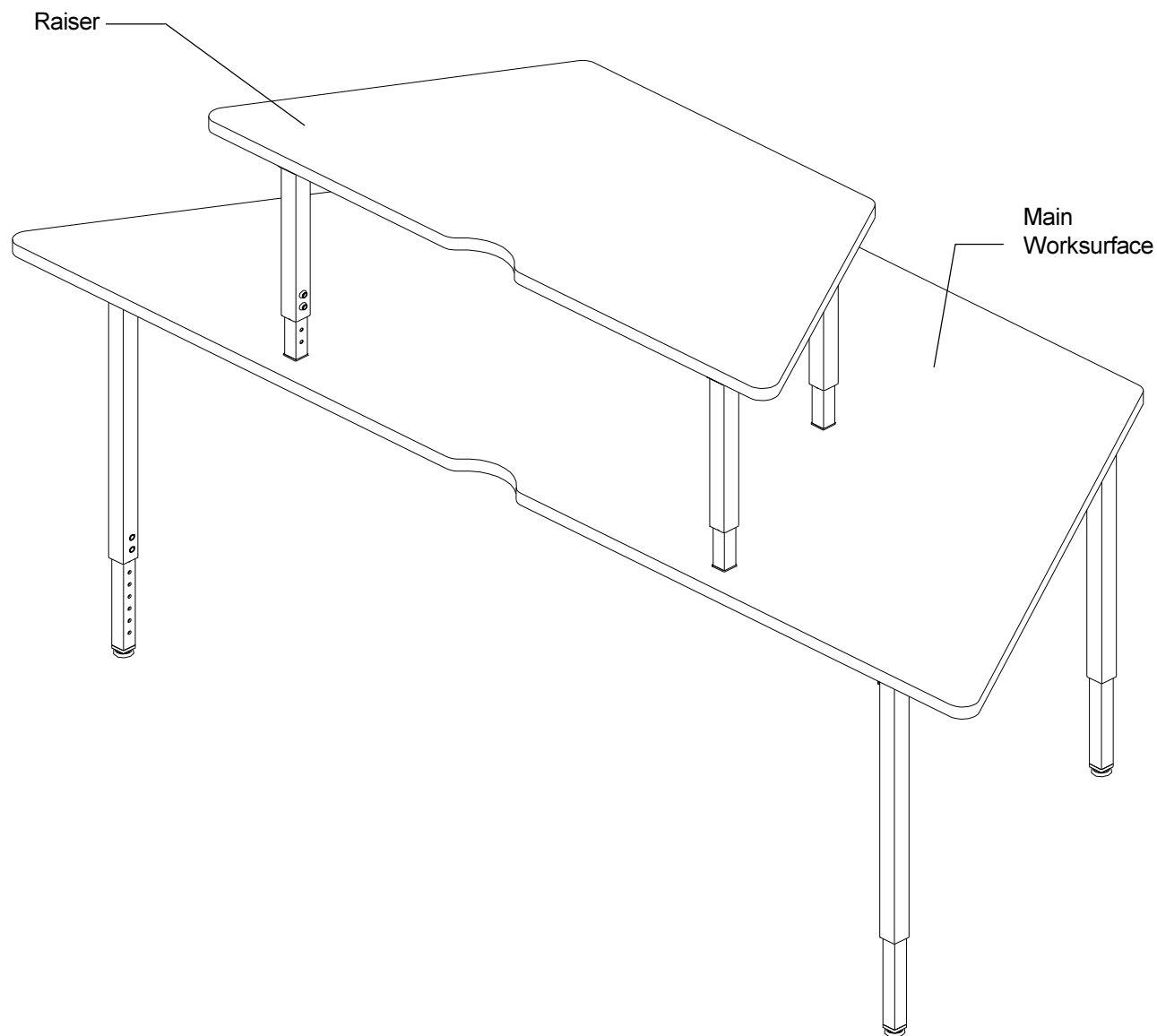

Bretford
11000 Seymour Avenue
Franklin Park, IL 60131
TEL: 847.678.2545
800.521.9614
FAX: 847.678.0852
800.343.1779

Bretford Ltd.
Technology House
7 Lake End Court, Taplow
Bucks SL6 0JQ England
TEL: 01628 603558
FAX: 01628 604923

www.bretford.com

Part#031-4813
Rev.05.16.02 IM