



BRETFORD

PRESENTATION ENVIRONMENTS®

MEDIA CART

Each Media Cart Contains:

- 2 - L/R Pedestal Upright Leg Assemblies
- 2 - Perforated Insert Panels
- 1 - Handle Assembly
- 1 - Bottom Shelf
- 3 - Adjustable Shelves (for 54" models)
- 2 - Adjustable Shelves (for 44" models)
- 2 - 4" Plate Casters w/ Brake
- 2 - 4" Plate Casters w/o Brake
- 6 - 1/4-20 Flange Nuts
- 30 - 1/4-20 x 5/8" Truss Head Screws
- 16 - 5/16-18 x 5/8" Hex Head Screws

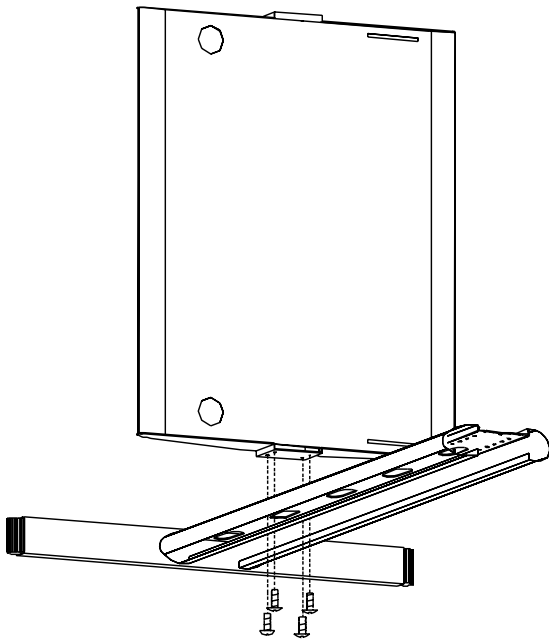
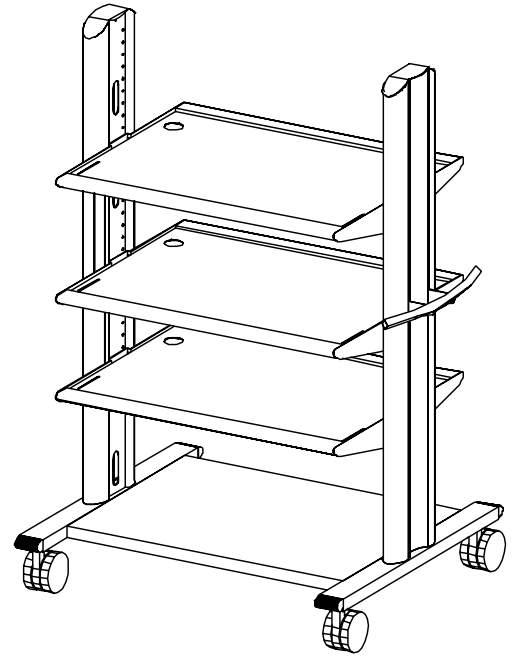

STEP 1

On a clean carpeted surface, block up leg assembly to provide access to shelf mounting screws. Loosely attach each shelf onto the leg assembly using the 1/4-20 x 5/8" truss head screws as shown. **NOTE:** The shelves can be positioned in any desired location; make sure the holes are positioned on the same side. Also, if you are attaching a cabinet to your cart, leave enough distance on the bottom for the cabinet.

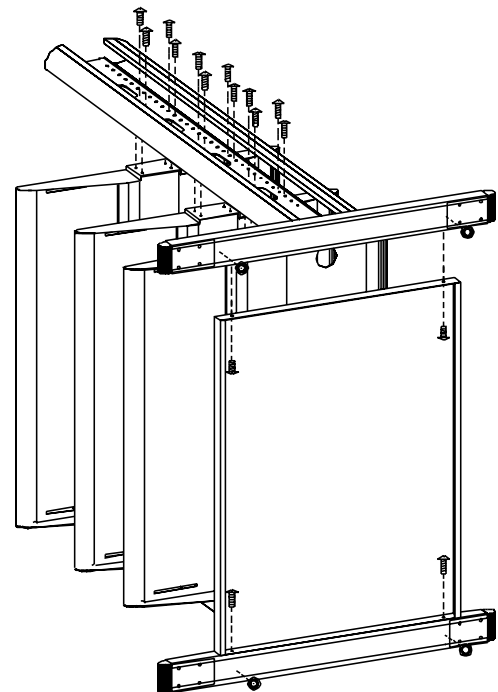
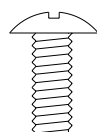

STEP 2

Attach the bottom shelf to the leg assembly using the 1/4-20 x 5/8" truss head screws and the 1/4-20 flange nuts as shown. Tighten both screw and nut. Then attach the other leg assembly to the bottom shelf as instructed above. Also loosely attach shelves to other leg as described in STEP 1.

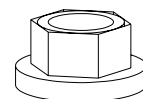

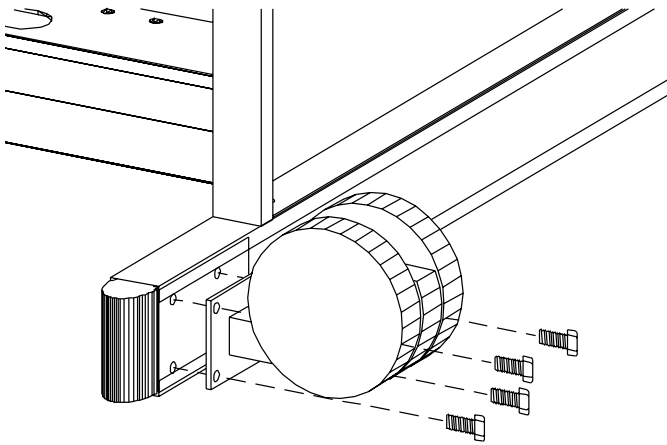

STEP 3

Attach casters to each corner of the leg assemblies as shown using the 5/16-18 x 5/8" hex head screws. Stand unit upright. Double check position of the shelf assemblies and tighten all screws.

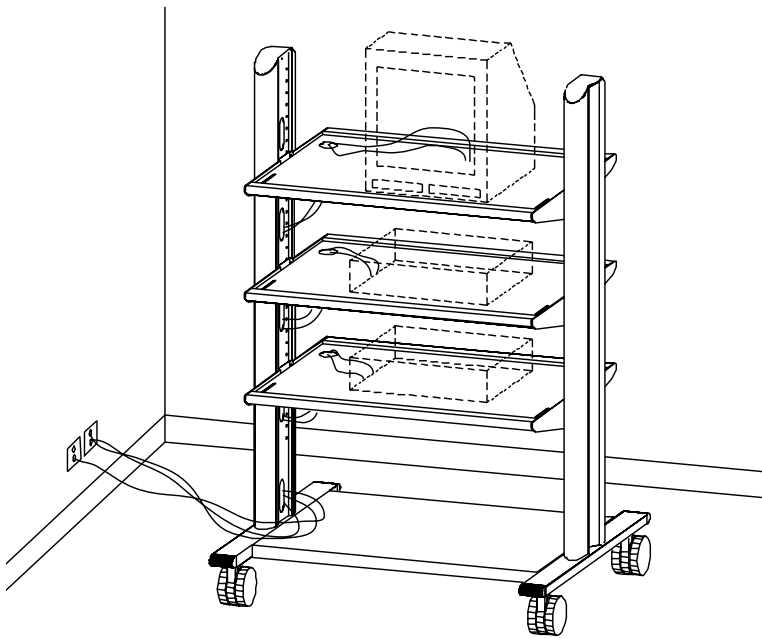
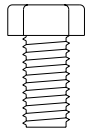

FIGURE 1

STEP 5

Prior to attaching the insert panels, run all necessary wiring through uprights (**Figure 1**). Remove the knurled screw from the top of the insert panel. Slide the insert panel between the uprights and position into the slots in the bottom of the leg (**Figure 2**). The top section will flap over the top of the uprights. Reinsert the knurled screw to connect the insert panel to the uprights.

NOTE: If you are attaching a cabinet to your cart, refer to the cabinet instructions now and resume this step after the cabinet is in place.

Bretford
 11000 Seymour Avenue
 Franklin Park, IL 60131
 TEL: 847.678.2545
 800.521.9614
 FAX: 847.678.0852
 800.343.1779

Bretford Ltd.
 Technology House
 7 Lake End Court, Taplow
 Bucks SL6 0JQ England
 TEL: 01628 603558
 FAX: 01628 604923

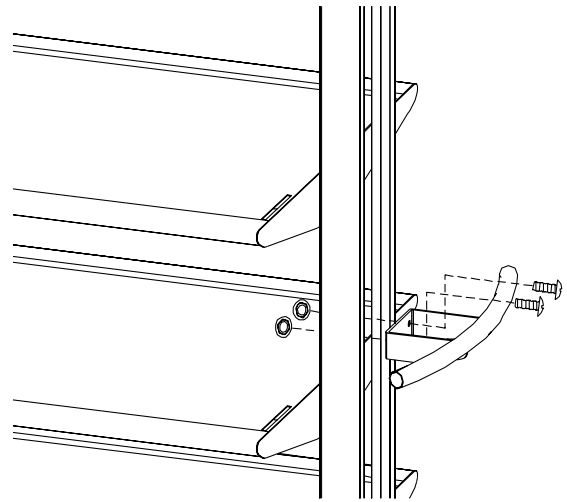

STEP 4

The handle assembly can be attached to either side of the cart and can be located at any height desired. Attach handle between uprights as shown using the 1/4-20 x 5/8" truss head screws and the 1/4-20 flange nuts. **NOTE:** If attaching the handle in line with a shelf, only the screws are necessary for attachment.

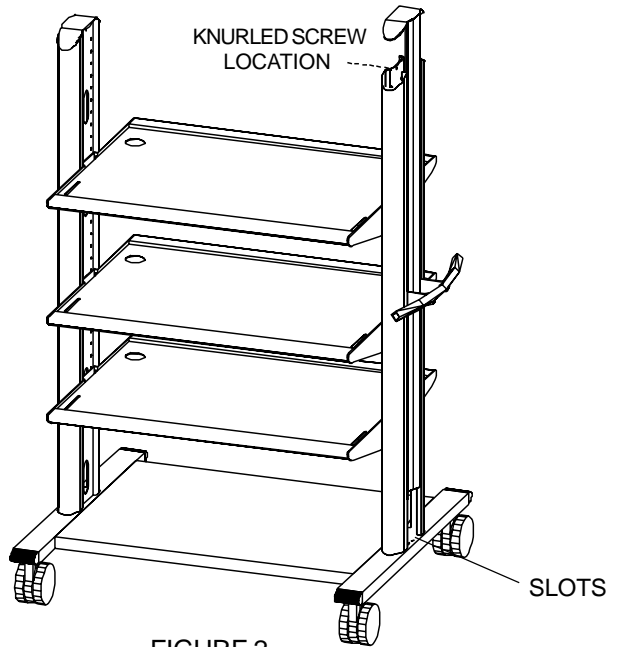

FIGURE 2