

PRESENTATION ENVIRONMENTS®

MEDIA CART WITH VERTICAL CPU CABINET

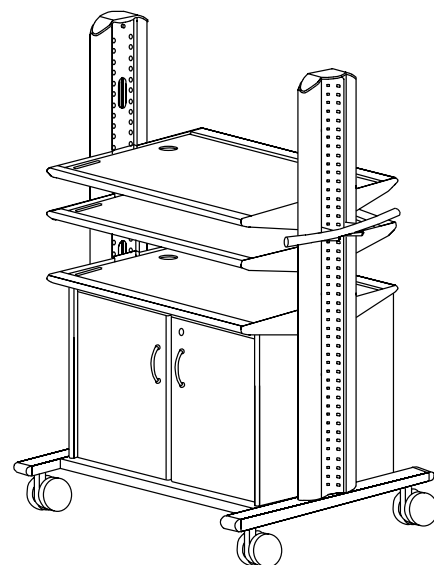

PARTS LIST

Qty	Description
1	Back Panel, Perforated - Removable with Lock
1	Back Cleat
1	Front Cleat
1	Right Side Panel
1	Left Side Panel
1	Right Door with Lock
1	Left Door
4	Hinge Plates
4	Hinges
2	Cabinet Brackets
1	Strike Plate
1	Lock with Key, Front Door
1	Lock with Key, Rear panel
2	Door Handles

HARDWARE LIST

Ref	Qty	Description
AA	4	Cam Lock
BB	4	Wood Dowel
CC	4	Locking Pin
DD	18	#6 x 5/8" Flat Head Wood Screw
EE	4	1/4-20 x 5/8" Combo Screw
FF	4	1/4-20 Flange Nut
GG	2	1/4-20 x 7/8" Flat Head Allen Screw
HH	2	#6 x 5/8" Type 'AB' Pan Head Screw
II	4	M4 x 23mm Multi-Head Machine Screw
JJ	2	3/16 Stud x 1.125 Collar Pin
KK	3	1/4-20 x 1/2" Truss Head Combo Screw
LL	2	1/2" Dia. Rubber Foot with self-adhesive
MM	2	#6 X 3/8" Type 'AB' Phillips Pan Head Screw
NN	2	Rubber Bumper
OO	4	#10-32 x 1/2" Phillips Truss Head Screws
	2	3/4" Felt Discs
	1	5/32" Allen Wrench

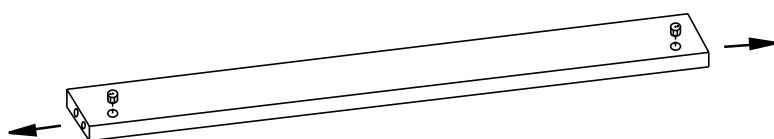

FRONT CLEAT

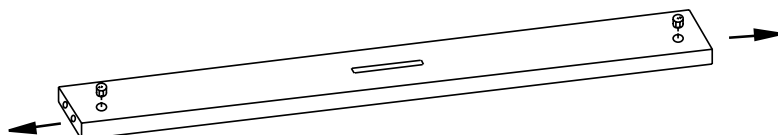

BACK CLEAT

← → = THE ARROW DIRECTION ON THE CAM LOCKS

STEP 1

Lay the front and back cleats on a carpeted surface with the holes facing upward. Insert the cam locks (AA) as shown. **NOTE:** The arrows on the **cams** should **face the edge holes**.

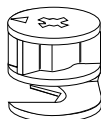

AA

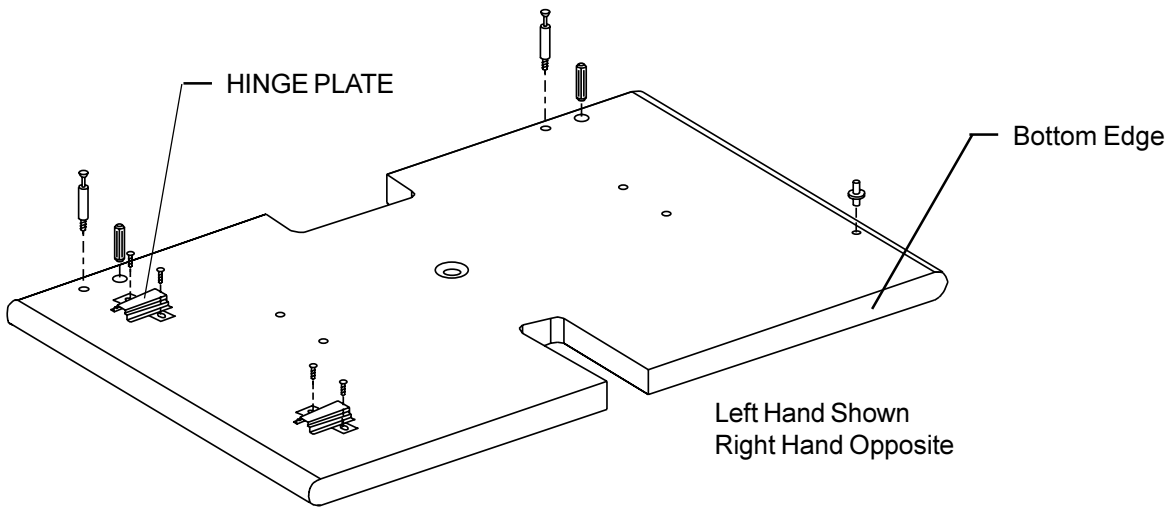

STEP 2

Lay both side panels down with holes facing upward. Attach the hinge plates with screws (DD) as shown. Insert dowels (BB), pins (CC) and collar pin (JJ) as shown. **NOTE:** Dowels in large holes and pins in small holes.

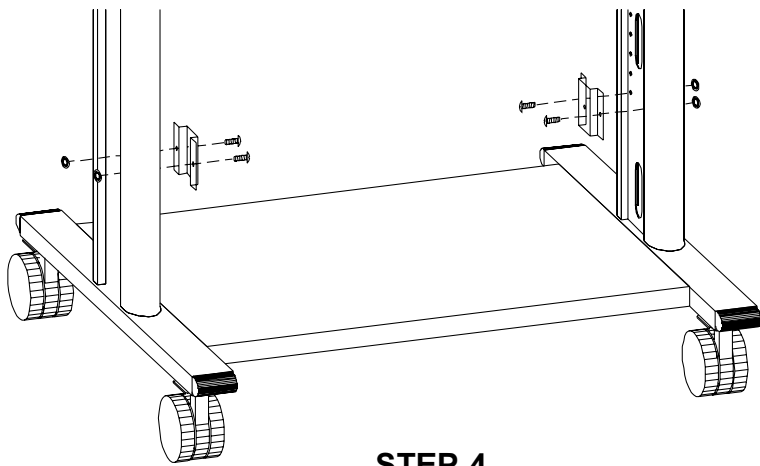
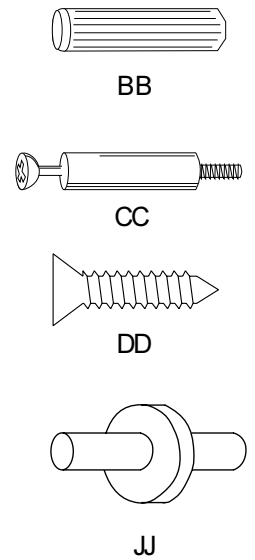

STEP 4

Raise the last adjustable shelf on the media cart high enough to allow space for the cabinet. Attach each cabinet bracket to the **LAST** set of holes on each upright as shown. Use screws (EE) and nuts (FF) to secure in place.

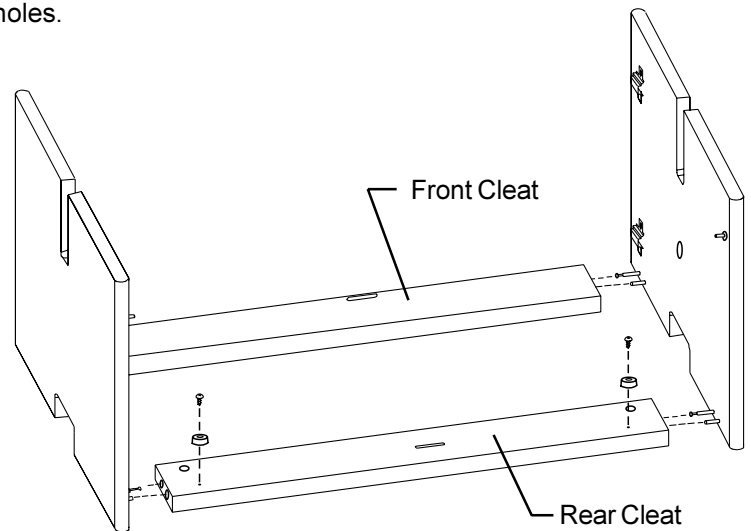
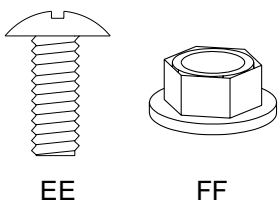

STEP 3

Attach the front and rear cleats to one side panel as shown. Then attach the other side panel. Flip cabinet up to expose cams on opposite side of cleats. Tighten all cams. **NOTE:** Slot on front cleat should face the inside of the cabinet doors. Install Rubber Bumpers (NN) with #6 x 3/8 screws (MM).

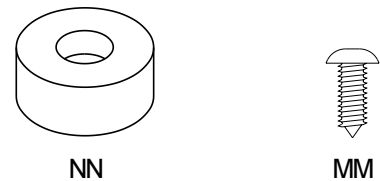

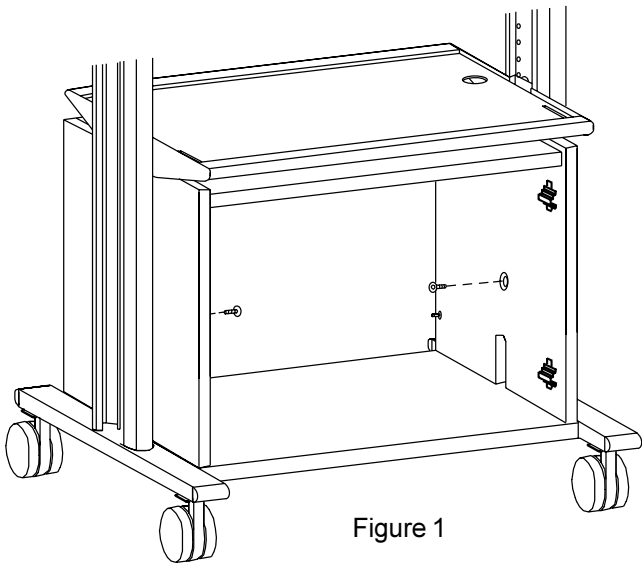
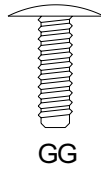

Figure 1



GG

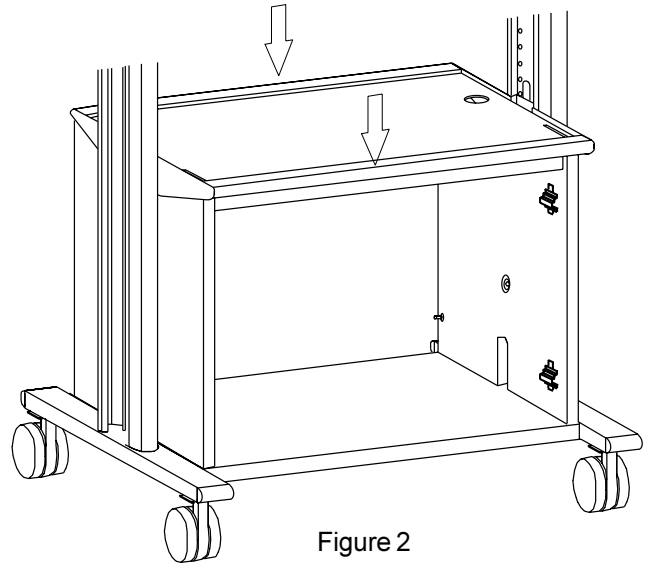

Figure 2

STEP 5

Position the cabinet on the bottom of the media cart. Secure in place using screws (GG) as shown in Figure 1. Once cabinet is secure, loosen the shelf and by holding onto the **MIDDLE** of the shelf **CAREFULLY** lower the shelf onto the cabinet. **LOOSELY** secure the shelf in place (See Figure 2).

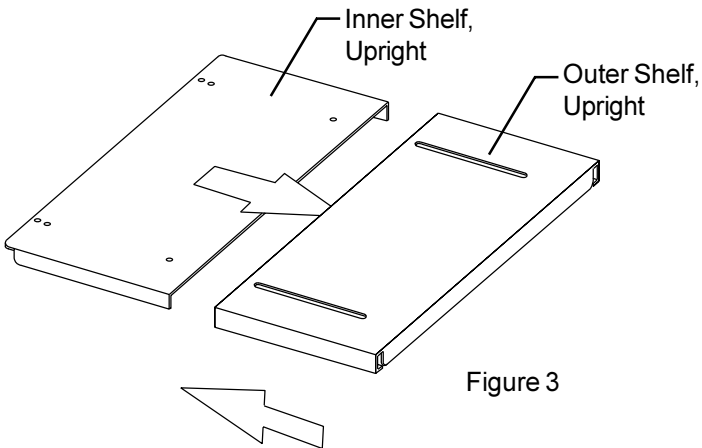

Figure 3

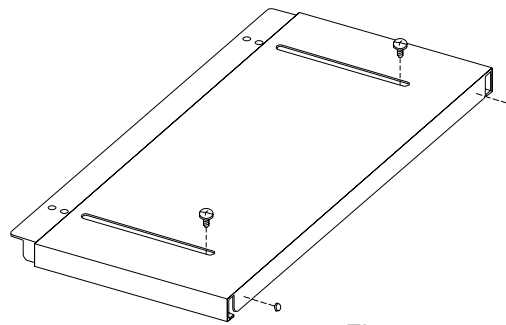
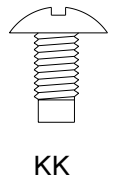

Figure 4



KK



LL

STEP 6

Position the uprights (inner and outer) to slide together as shown in Figure 3. Install the 1/4-20 hardware (KK) **Do not tighten**. Adhere (2) 1/2" Dia. rubber feet (LL) approximately as shown in Figure 4.

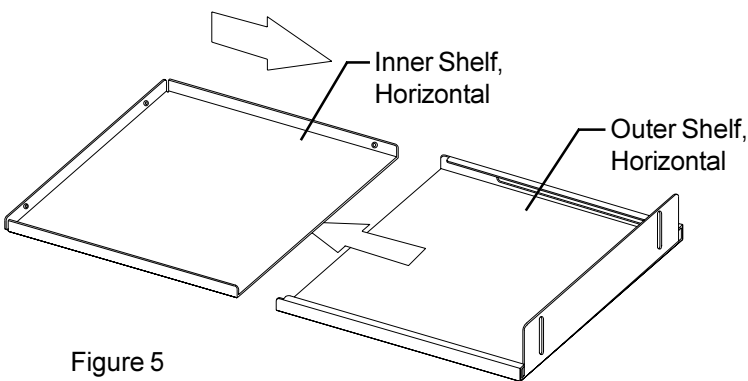

Figure 5

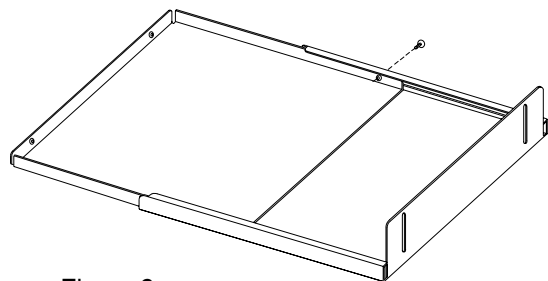

Figure 6

STEP 7

Position the horizontal shelves (inner and outer) to slide together as shown in Figure 5. Install the (1) 1/4-20 hardware (KK) as shown in Figure 6. **Do not tighten screw.**

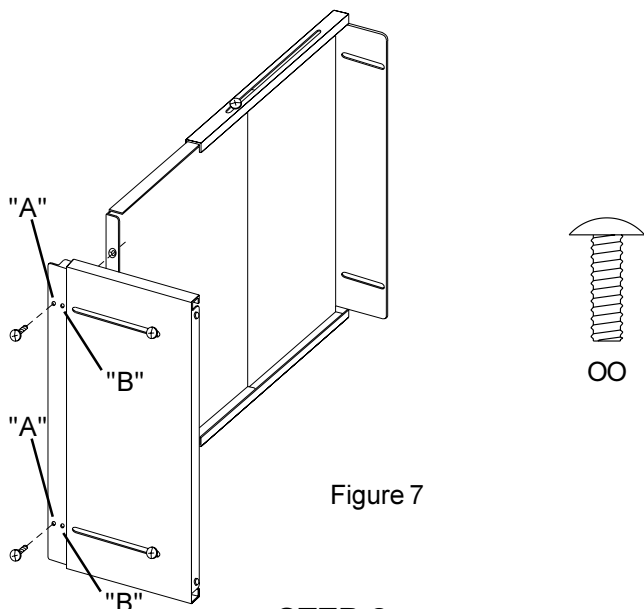

Figure 7

STEP 8

Assemble the upright and horizontal units as shown in Figure 7 (**Note:** When using the "A" holes, this will give a "flush corner". When using the "B" holes, this will give a "lip corner"). Install (2) 1/4-20 screws and tighten.

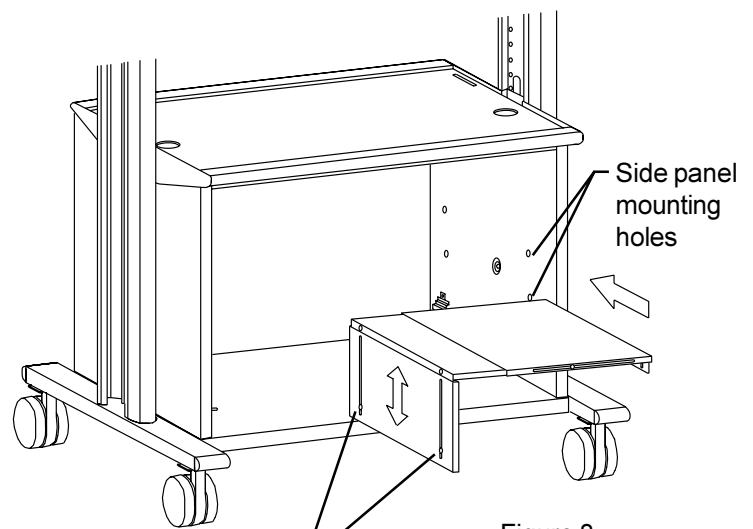

Figure 8

STEP 9

10-32 x 1/2" screws for upright, height adjustment

From the rear of the cart, position the shelf assembly as shown in Figure 8. Determine your height requirement utilizing the mounting holes on the interior wall of the cart side panel. Then tighten the (2) 10-32 screws (OO) on the shelf upright (See Figure 8).

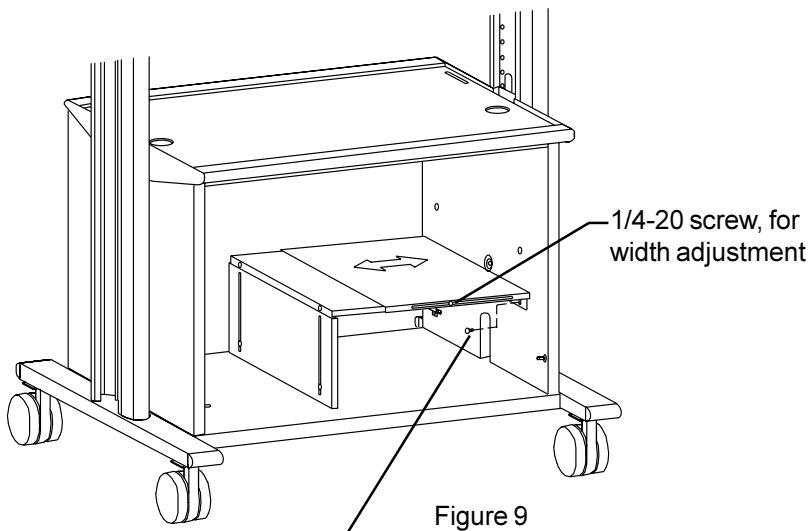
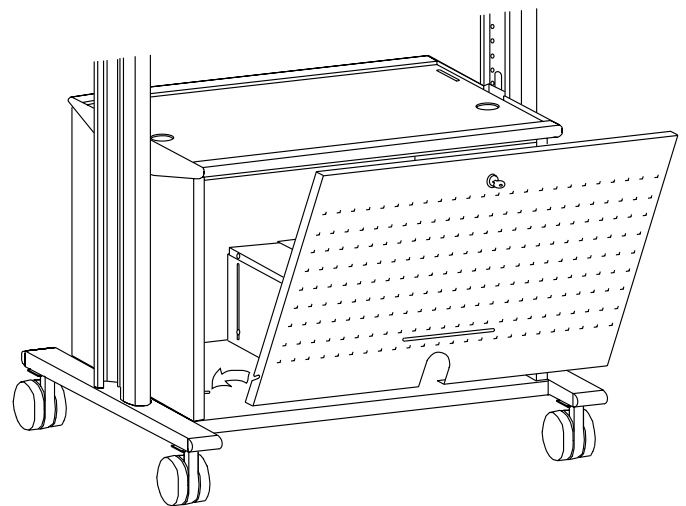

Figure 9

STEP 10

10-32x1/2" screws, to attach shelf to side panel

Install 10-32 screws (OO) to horizontal shelf and tighten. This will secure the shelf to the cart cabinet. The width of the shelf can be adjusted at this point before tightening the 10-32 screw (OO).



STEP 11

Attach the rear panel by lining up the pivot slot of the rear panel and the pivot post (JJ) of the cart cabinet as shown. Close the rear panel and lock it to complete the installation.

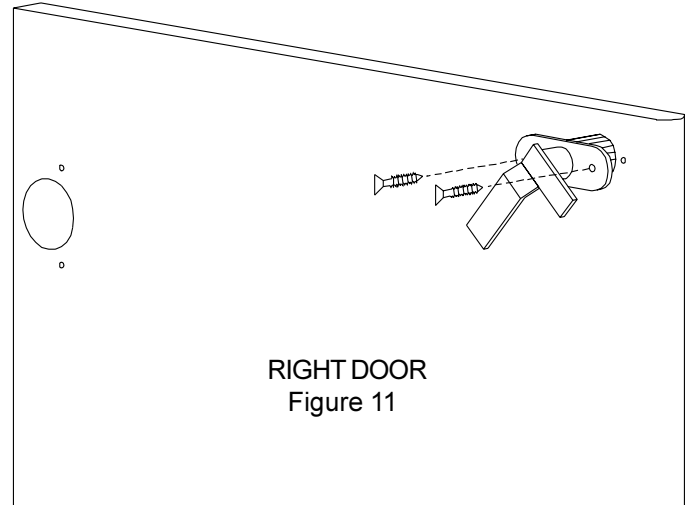
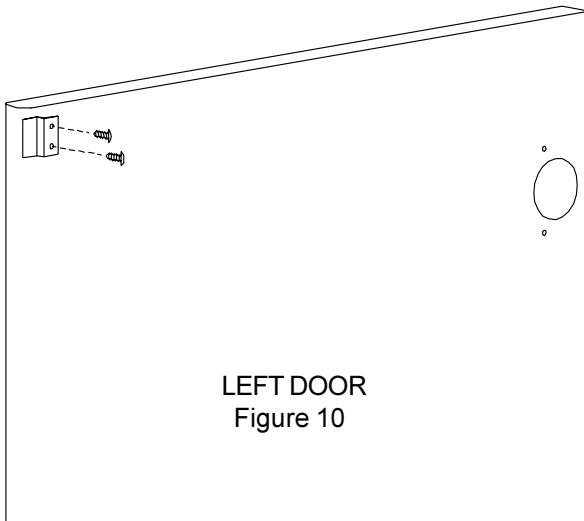

STEP 12

Attach the strike plate to the top of the left door with screws (HH) as shown in **FIGURE 10**. Attach the lock assembly to the top of the right door using screws (DD) as shown in **FIGURE 11**. Attach a felt disc in each door corner. **NOTE:** Make sure the lock is positioned as it is shown or it will not work properly.

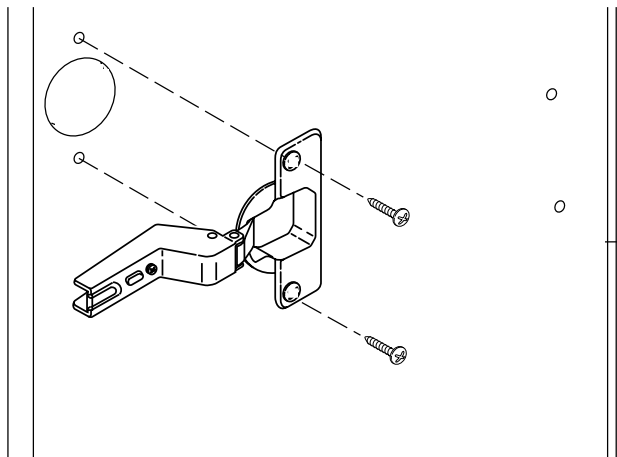
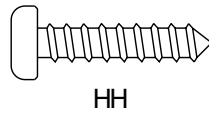

STEP 13

Attach hinges to the inside of each door as shown using screws (DD).

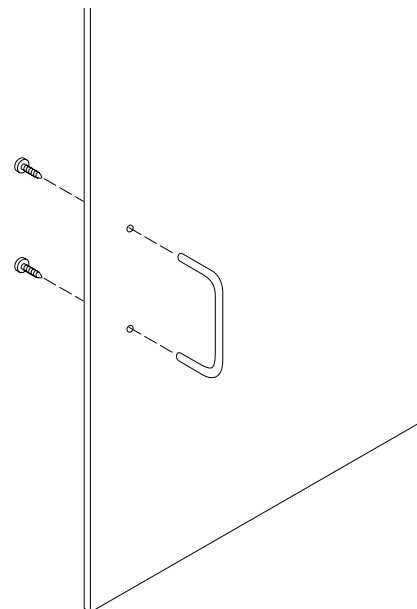

STEP 14

Attach handles to the outside of each door as shown using screws (II).



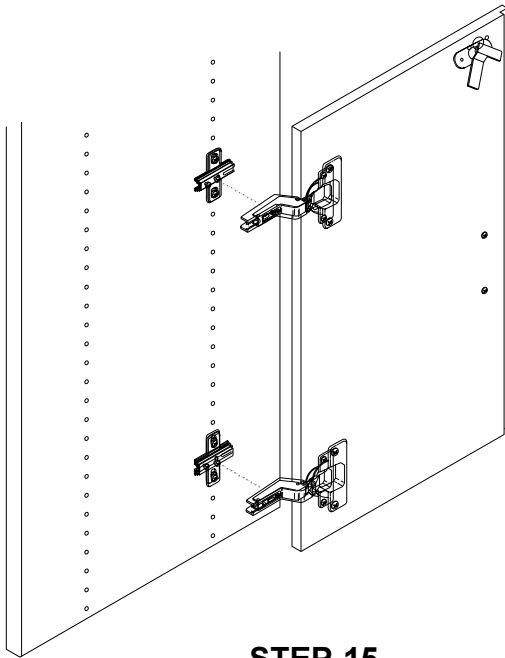

STEP 15

Attach each door so that the hinges slide over the hinge plates. Make sure that the screw in the plate slides into the groove on the hinge.

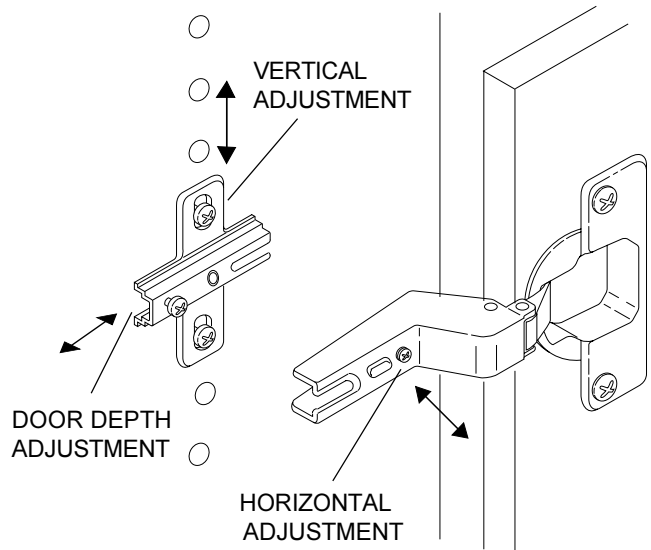

STEP 16

Adjust each hinge as necessary to make sure the doors meet properly. The illustration indicates which screw will effect the adjustment of the door.

NOTE: Once final adjustments are made to doors, make sure the shelf is positioned correctly so that the doors do not rub on the shelf when opening and closing. Adjust the shelf up or down if necessary and make sure it is level. **TIGHTEN** shelf in place.

Bretford
 11000 Seymour Avenue
 Franklin Park, IL 60131
 TEL: 847.678.2545
 800.521.9614
 FAX: 847.678.0852
 800.343.1779

Bretford Ltd.
 2 Etongate
 110 Windsor Road
 Slough, Berkshire SL1 2JA England
 TEL: 01753 216531
 FAX: 01753 539478

www.bretford.com

Part#031-3129
 Rev. 04.01.05 CH

Presentation Environments® is a registered trademark of Bretford Manufacturing Inc.