

BRETFORD BASICS™

QUATTRO TRAPEZOID COMPUTER TABLES

The Quattro Trapezoid Tables accommodate all ages with adjustable heights; adult height tables meet ADA requirements. Tables are trapezoid shaped thus allowing them to be placed against a wall or back to back for a learning cluster.



QWTR80 & QWTSHLF80 in
Grey Mist & Quartz (-GMQ)

FEATURES

- Work surface is adjustable in one inch increments from 24" to 32" high, meeting ADA requirements.
- Trapezoid tables hold three computer workstations and are available in a 80" and 96" wide worksurface.
- Table has a cord cut out at the back of the table and a vertical cord management bin for organizing wires.
- Optional top shelf is independently height adjustable from 16" to 20" above the worksurface.
- Sturdy 1" thick laminate top with steel skirt and base provide a sturdy work surface for the heaviest of equipment. Trapezoid worksurfaces meet ANSI/BIFMA safety and quality standards.
- Reinforced worksurface leg design is constructed from 12- and 14-gauge steel providing superior strength and stability.
- Trapezoid tables come with adjustable floor glides only.
- Optional 6-outlet electrical unit (ECF6) or 12-outlet electrical unit (E12) have single switch power control and attaches to pre-drilled holes in the cord management bin or screws to the underside of the work surface.
- Work surface uses a substrate that is comprised of a minimal 40% and average 70% recycled materials and the base is constructed with "prime" steel which is constructed with 25%-35% post-consumer recycled steel.
- Complies with the GREENGUARD Environmental Institute's GREENGUARD Children & Schools Indoor Air Quality standards, contributing to points toward Leadership in Energy and Environmental Design (LEED) Certification.
- Made in the USA.

OVERALL DIMENSIONS

QWTR80-__	80" w x 40" d x 24-32" h
QWTR96-__	96" w x 50" d x 24-32" h
QWTSHLF80-__	46-1/8" w x 24" d x 16-20" h
QWTSHLF96-__	48-3/4" w x 26" d x 16-20" h

COLOR/FINISH

Base/Tabletops: Grey Mist powder paint/Grey Mist laminate (-GM_) or Black powder paint/Wild Cherry laminate (-CY)

Trim, Toe Caps & Grommet Holes (on Grey Mist tables only): Available in Cardinal (GMC), Topaz (GMT), Polo (GML) and Quartz (GMQ)

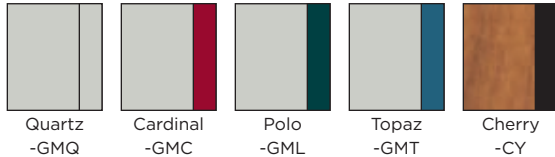

STANDARD EQUIPMENT

- 1" laminate table top with grommet(s)
- Leg assemblies (4)
- Adjustable leg glides (4)
- Vertical cord management bin (1)

ACCESSORIES

ECF6	6-Outlet Electrical Unit
E12	12-Outlet Electrical Unit

WEIGHT AND FREIGHT CLASS

QWTR80-__	149 lbs., Freight class 70
QWTR96-__	195 lbs., Freight class 70
QWTSHLF80-__	55 lbs., Freight class 70
QWTSHLF96-__	60 lbs., Freight class 70

Ships ready to assemble.

SUGGESTED SPECIFICATIONS

Quattro Computer Trapezoid Tables are height adjustable from 24" to 32" in 1" increments. Available in 80" and 96" widths depending on the model specified. Laminate table top is made from 1" thick, 45 lb. density particle board and 3mm thick vinyl T-molding. Table top features a cut out at the back to facilitate cord management. A 18-gauge steel cord management bin runs from the cord cut out on the table top to the floor. Table top incorporates a 14-gauge steel apron around the table edge. Telescoping legs are constructed from 1 1/4" 12-gauge steel and 1" 14-gauge steel tubing and attach to the top using a unique hex/tie bolt assembly. Table is available in a Wild Cherry wood grain laminate with Black T-molding and Black powder paint base or with a Grey Mist laminate with Quartz, Cardinal, Polo or Topaz T-molding and a Grey Mist powder paint base. Trapezoid Shelves are constructed of the same materials as the table. The shelf is height adjustable from 16-20". The shelf is attached to the table with screws which go through the table top into the bottom of the front two legs. Shelf is available in the same finishes as the table. All steel components are constructed with "prime" steel which has a 25% to 35% post-consumer recycled content. Table are GREENGUARD INDOOR AIR QUALITY CERTIFIED®.

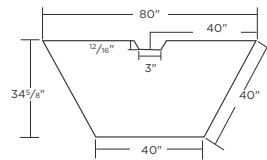

80"W TRAPEZOID COMPUTER TABLE

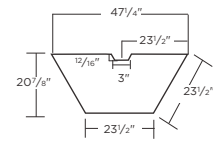

TOP SHELF FOR 80"W TRAPEZOID COMPUTER TABLE

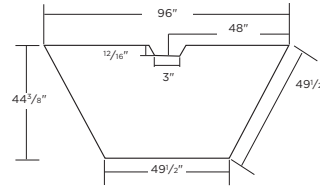

96"W TRAPEZOID COMPUTER TABLE

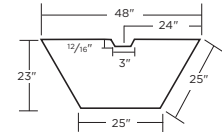

TOP SHELF FOR 96"W TRAPEZOID COMPUTER TABLE

MADE IN THE USA

All Quattro series tables are made at one of Bretford's Chicago area manufacturing facilities using union labor.

UPC CODES

QWTR80-CY:	Box 1 - 0 96633 19899 3	Box 2 - 0 96633 19998 3
QWTR80-GMC:	Box 1 - 0 96633 19979 2	Box 2 - 0 96633 19903 7
QWTR80-GML:	Box 1 - 0 96633 19980 8	Box 2 - 0 96633 19903 7
QWTR80-GMQ:	Box 1 - 0 96633 19900 6	Box 2 - 0 96633 19903 7
QWTR80-GMT:	Box 1 - 0 96633 19981 5	Box 2 - 0 96633 19903 7
QWTR96-CY:	Box 1 - 0 96633 19901 3	Box 2 - 0 96633 19998 3
QWTR96-GMC:	Box 1 - 0 96633 19982 2	Box 2 - 0 96633 19903 7
QWTR96-GML:	Box 1 - 0 96633 19983 9	Box 2 - 0 96633 19903 7
QWTR96-GMQ:	Box 1 - 0 96633 19902 0	Box 2 - 0 96633 19903 7
QWTR96-GMT:	Box 1 - 0 96633 19984 6	Box 2 - 0 96633 19903 7
QWTSHLF80-CY	0 96633 19895 5	
QWTSHLF80-GMC	0 96633 19971 6	
QWTSHLF80-GML	0 96633 19972 3	
QWTSHLF80-GMQ	0 96633 19973 0	
QWTSHLF80-GMT	0 96633 19974 7	
QWTSHLF96-CY	0 96633 19897 9	
QWTSHLF96-GMC	0 96633 19975 4	
QWTSHLF96-GML	0 96633 19976 1	
QWTSHLF96-GMQ	0 96633 19977 8	
QWTSHLF96-GMT	0 96633 19978 5	



11000 SEYMOUR AVENUE
FRANKLIN PARK, ILLINOIS 60131 USA
TOLL FREE PHONE 800-521-9614
PHONE 847-678-2545
TOLL FREE FAX 800-343-1779
FAX 847-678-0852
WWW.BRETFORD.COM